

1 2 3 4

9. EXPLODED VIEWS AND PARTS LIST

NOTES: ● Parts marked by "NSP" are generally unavailable because they are not in our Master Spare Parts List.

● The \triangle mark found on some component parts indicates the importance of the safety factor of the part. Therefore, when replacing, be sure to use parts of identical designation.

● Screws adjacent to ∇ mark on product are used for disassembly.

● For the applying amount of lubricants or glue, follow the instructions in this manual.

(In the case of no amount instructions, apply as you think it appropriate.)

9.1 PACKING SECTION

The diagram illustrates the packing section for the MEP-7000. It shows the following components and their assembly:

- Parts 4-10:** Various cables and connectors.
- Parts 11-15:** Panels and covers, with callouts for '(WYXJ5 only)' and '(KUCXJ only)'.
- Parts 16-17:** Bags for cables, with callout '(WYXJ5 only)'.
- Parts 18-20:** Rack components, including a main rack (20) and side rails (18).
- Part 21:** The final shipping box.
- Callouts:** '(TLFXJ only)' is shown for parts 2 and 3.

134

MEP-7000

1 2 3 4

(1) PACKING SECTION PARTS LIST

<u>Mark No.</u>	<u>Description</u>	<u>Part No.</u>	<u>Mark No.</u>	<u>Description</u>	<u>Part No.</u>
⚠ 1	Power Cord	See Contrast table (2)	NSP 14	Warranty Card	See Contrast table (2)
⚠ 2	Power Cord	See Contrast table (2)	NSP 15	Warranty Card	See Contrast table (2)
3	Caution Card SB	See Contrast table (2)	16	Operating Instructions	See Contrast table (2)
4	Dedicated Remote Control Cable	DDE1115	NSP 17	Polyethylene Bag (0.06 x 230 x 340)	AHG7117
5	USB Cable	DDE1128	18	Pad (PL)	DHA1765
6	USB Auxiliary Power Cable	DDE1129	19	Pad (CNT)	DHA1766
7	Audio Cable	XDE3045	20	Packing Sheet	RHC1023
8	Control Cord	XDE3063	21	Packing Case	See Contrast table (2)
9	Forced Ejection Pin	DEX1008	22	Separator	DHA1773
10	Caution Tag AP	DRW1897	23	Spacer	DHA1772
11	Operating Instructions	See Contrast table (2)			
12	DJS CD-ROM Assy	See Contrast table (2)			
NSP 13	DJS Installation Key Sticker	See Contrast table (2)			

(2) CONTRAST TABLE

MEP-7000/KUCXJ, WYXJ5, TLFJX and WAXJ5 are constructed the same except for the following:

Mark	No.	Symbol and Description	MEP-7000/KUCXJ	MEP-7000/WYXJ5	MEP-7000/TLFJX	MEP-7000/WAXJ5
⚠	1	Power Cord	ADG7021	ADG1154	ADG1154	ADG7079
⚠	2	Power Cord	Not used	Not used	ADG7097	Not used
	3	Caution Card SB	Not used	Not used	ARM7064	Not used
	11	Operating Instructions (English)	DRB1455	Not used	Not used	Not used
	11	Operating Instructions (English / French / German)	Not used	DRB1456	Not used	Not used
	11	Operating Instructions (Chinese / English / Spanish)	Not used	Not used	DRB1457	DRB1458
	12	DJS CD-ROM Assy	DXX2585	DXX2585	DXX2585	Not used
NSP	13	DJS Installation Key Sticker	DRM1300	DRM1300	DRM1300	Not used
NSP	14	Warranty Card	ARY7043	Not used	Not used	Not used
NSP	15	Warranty Card (WY)	Not used	ARY7107	Not used	Not used
	16	Operating Instructions (Italian / Dutch / Spanish / Russian)	Not used	DRB1464	Not used	Not used
	21	Packing Case	DHG2742	DHG2743	DHG2744	DHG2745

9.2 EXTERIOR SECTION

1 2 3 4

A

Note: When reassembling the upper panel (42), tighten Screws A first then Screws B.

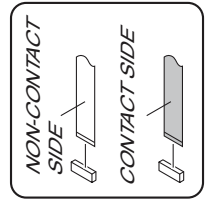

B

Refer to "9.4 SLOT-IN MECHA SECTION".

C

D

E

F

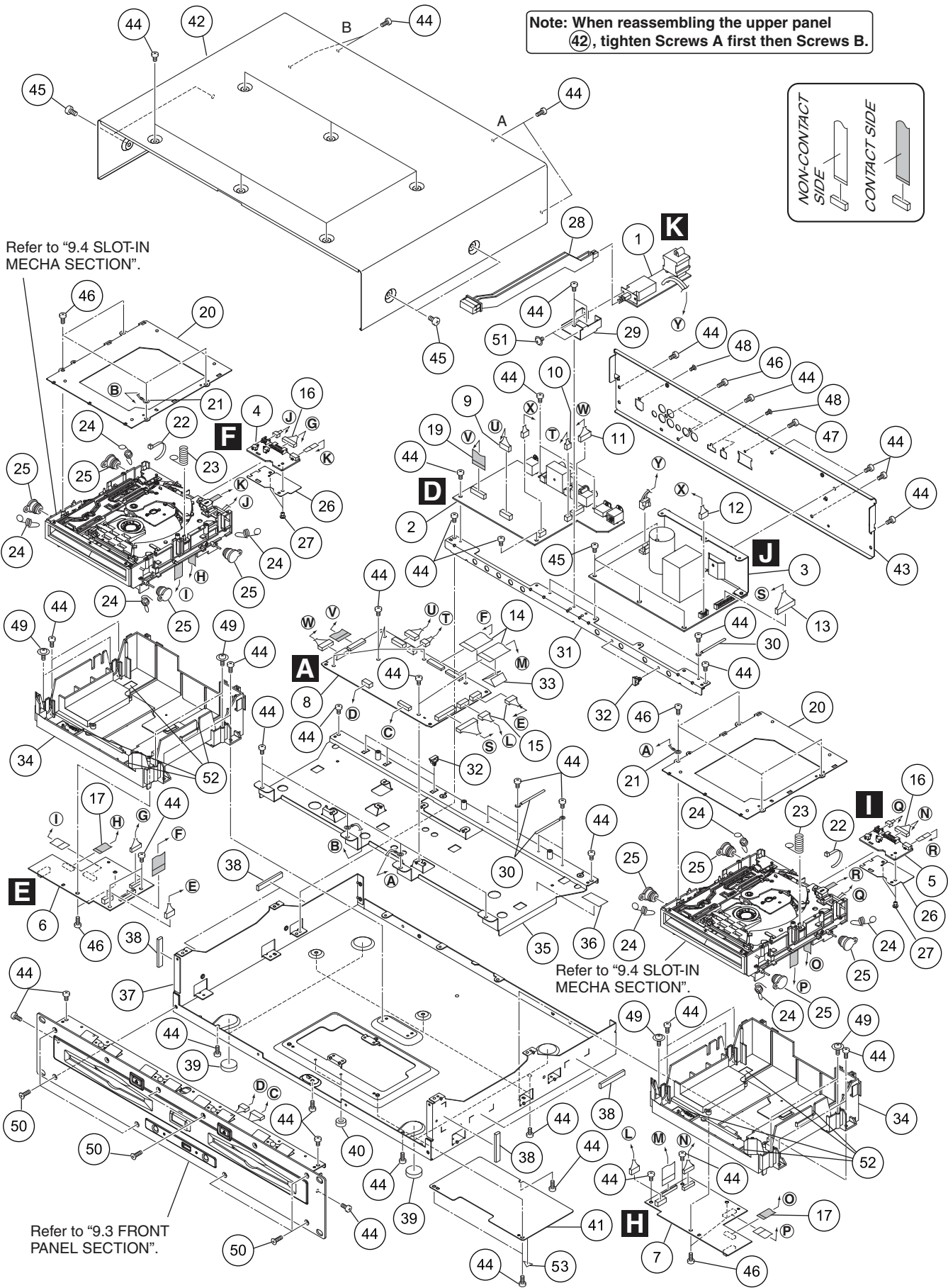

Refer to "9.3 FRONT PANEL SECTION".

Refer to "9.4 SLOT-IN MECHA SECTION".

1 2 3 4

(1) EXTERIOR SECTION PARTS LIST

<u>Mark No.</u>	<u>Description</u>	<u>Part No.</u>	<u>Mark No.</u>	<u>Description</u>	<u>Part No.</u>
1	ACIN Assy	See Contrast table (2)	28	Power Knob	DNK4900
2	SJACK Assy	DWX2710	29	SW Bracket	DNH2786
⚠ 3	POWER SUPPLY Unit	DWR1440	30	Cord Clamper	RNH-184
4	SLMB1 Assy	DWS1401			
5	SLMB2 Assy	DWS1402	31	Rear Stay	DNH2785
			32	Locking Mini Clamp	DEC2439
6	SRV1 Assy	DWX2711	33	EMC Sheet 20x55	DEC3096
7	SRV2 Assy	DWX2712	34	Mecha Base	DNK4906
8	SMAIN Assy	DWX2706	35	PCB Stay Assy	DXB1988
9	Connector Assy 7P	PF07PP-C15			
10	Connector Assy 3P	PF03PP-C17	36	Laser Caution	See Contrast table (2)
			NSP 37	Chassis	DNA1358
11	Connector Assy 8P	PF08PP-C27	38	Gasket	DEC3080
12	Connector Assy 5P	DKP3784	39	Insulator	DEC2348
13	Connector Assy 15P	DKP3783	NSP 40	Spacer	AEB7092
14	40P FFC	DDD1355			
15	Connector Assy 5P	PF05PP-C37	41	Bottom Plate	DNH2784
			42	Bonnet (BOX)	DXX2592
16	Connector Assy 9P	DKP3782	43	Rear Panel	See Contrast table (2)
17	24P FFC	DDD1357	44	Screw	BBZ30P060FTB
18	•••••		45	Screw	BBZ40P080FTB
19	20P FFC	DDD1402			
20	Mecha Plate	DNH2642	46	Screw	BPZ30P080FTC
			47	Screw	PBZ30P080FTB
21	Earth lead Unit	DDF1035	48	Screw(M3x5)	DBA1340
22	Binder	ZCA-SKB90BK	49	DM Screw(FTC)	DBA1260
23	Earth Spring	DBH1398	50	Screw	CMZ30P080FTB
24	Float Spring G5	DBH1494			
25	Damper	CNV6011	51	Screw	AMZ30P040FTC
			52	Float Cushion	DEC3121
26	PCB Shield SLMB	DEC3059	NSP 53	Label	See Contrast table (2)
27	Rivet 3x4.5	RBM-003			

(2) CONTRAST TABLE

MEP-7000/KUCXJ, WYXJ5, TLFXJ and WAXJ5 are constructed the same except for the following:

Mark	No.	Symbol and Description	MEP-7000/KUCXJ	MEP-7000/WYXJ5	MEP-7000/TLFXJ	MEP-7000/WAXJ5
	1	ACIN Assy	DWR1438	DWR1439	DWR1439	DWR1439
	36	Laser Caution	VRW2257	VRW2257	VRW2159	DRW2372
	43	Rear Panel	DNC1823	DNC1851	DNC1908	DNC1853
NSP	53	Label	DRW1975	Not used	Not used	Not used

9.3 FRONT PANEL SECTION

A

B

C

D

E

F

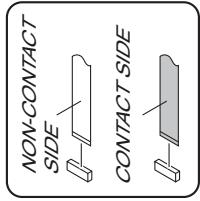
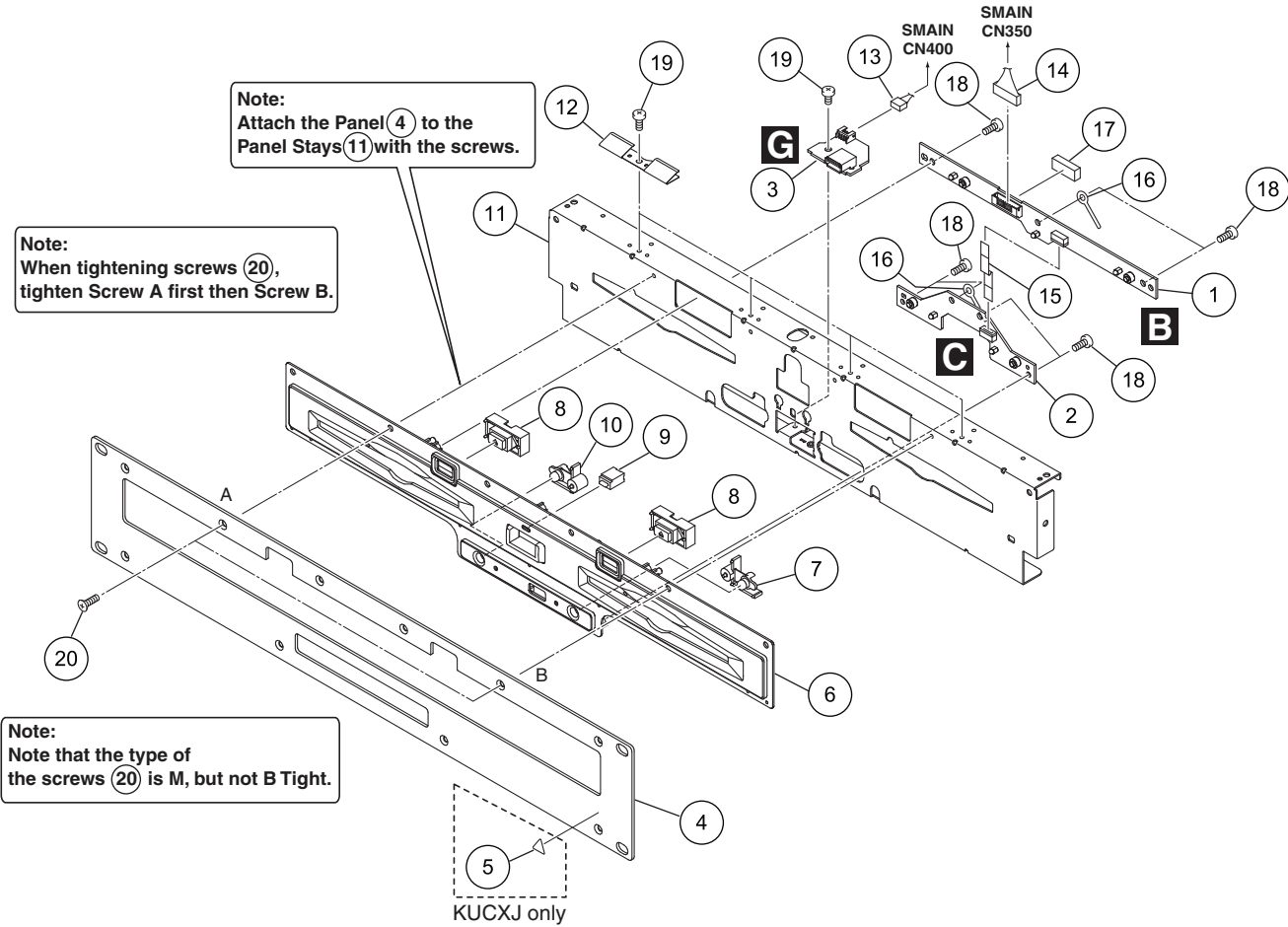

(1) FRONT PANEL SECTION PARTS LIST

<u>Mark No.</u>	<u>Description</u>	<u>Part No.</u>	<u>Mark No.</u>	<u>Description</u>	<u>Part No.</u>
1	EJTB Assy	DWS1403	12	Earth Plate L	DBK1319
2	FSWB Assy	DWS1400	13	Connector Assy 4P	PF04PP-C10
3	USBB Assy	DWX2713	14	Connector Assy 10P	DKP3781
4	Front Panel	DNB1149	15	6P FFC	DDD1403
NSP 5	Label	See Contrast table (2)	16	Cord Clamper	RNH-184
6	Slot Panel	DNK4899	17	FFC Guard	DEC2586
7	STOP Knob R	DNK4903	18	Screw	BPZ30P080FTC
8	EJECT Knob (PL)	DNK4901	19	Screw	BBZ30P060FTB
9	Lens A	DNK4904	20	Screw	CMZ30P080FTB
10	STOP Knob L	DNK4902			
11	Panel Stay	DNH2837			

(2) CONTRAST TABLE

MEP-7000/KUCXJ, WYXJ5, TLFXJ and WAXJ5 are constructed the same except for the following:

Mark	No.	Symbol and Description	MEP-7000/KUCXJ	MEP-7000/WYXJ5	MEP-7000/TLFXJ	MEP-7000/WAXJ5
NSP	5	Label	DRW1975	Not used	Not used	Not used

9.4 SLOT-IN MECHA SECTION

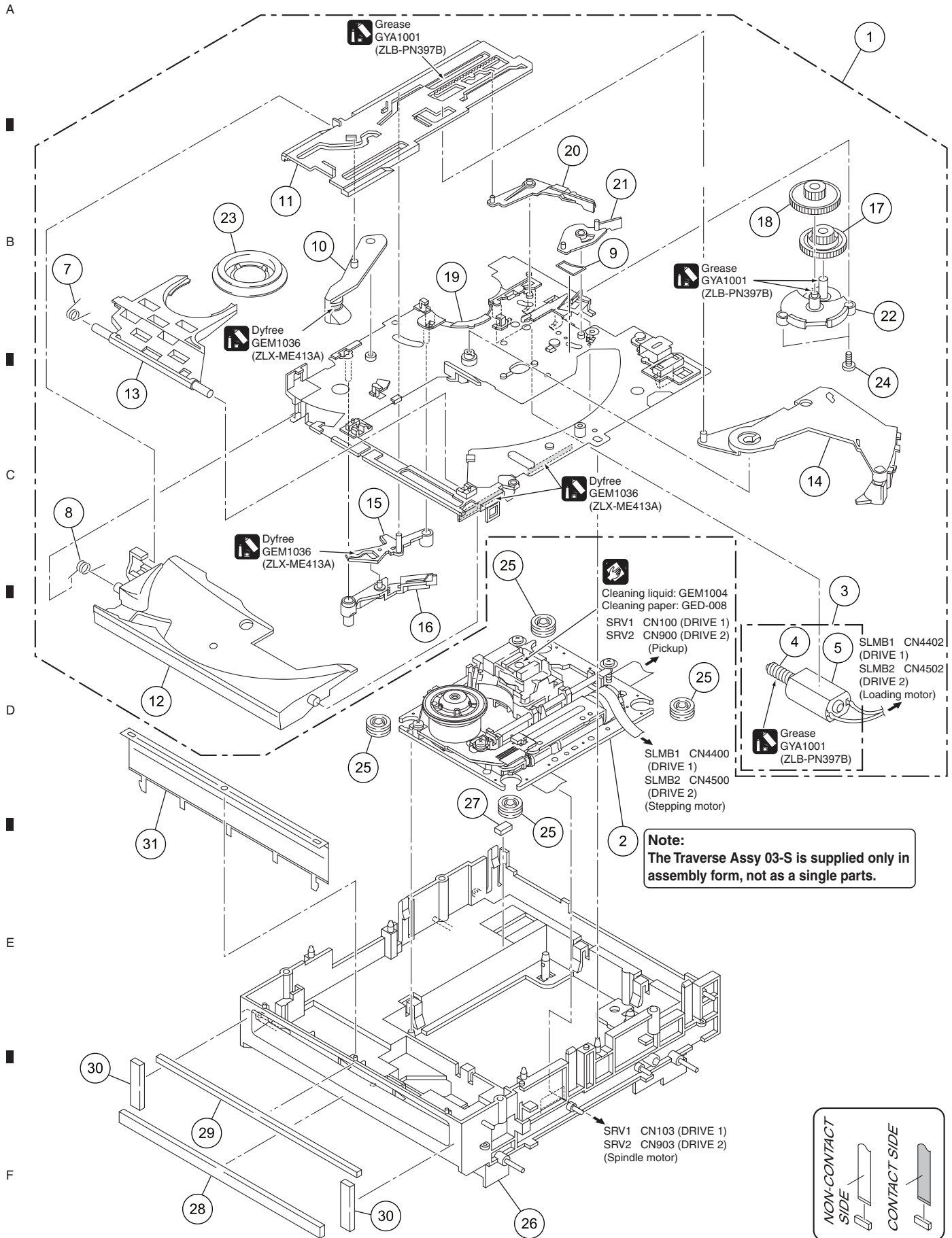

(1) SLOT-IN MECHA SECTION PARTS LIST

<u>Mark No.</u>	<u>Description</u>	<u>Part No.</u>
NSP 1	Slot-in Mechanism Assy	DXA2123
2	Traverse Assy 03-S	VXX3125
3	Loading Motor Assy-S	DXX2510
NSP 4	Worm Gear	DNK3910
NSP 5	DC Motor S (ROHS)	DXM1230
6	•••••	
7	Clamp Spring	DBH1374
8	Guide Spring	DBH1375
9	SW Lever Spacer SV	DEC2831
10	Loading Gear Assy	DXB1880
11	Main Cam	DNK3407
12	Disc Guide	DNK3478
13	Clamp Arm	DNK3576
14	Eject Lever	DNK3684
15	Lever AP	DNK3835
16	Lever BP	DNK3836
17	Loading Gear	DNK3911
18	Drive Gear	DNK3912
19	Loading Base SV	DNK4369
20	SW Lever SV1	DNK4370
21	SW Lever SV2	DNK4371
22	Gear Holder SV	DNK4372
23	Clamper 04 Assy	DXX2591
24	Screw	BPZ20P060FTC
25	Float Rubber (SI)	VEB1351
26	Float Base 04 Assy	DXB1838
27	Spacer (T3)	DEB1566
28	Vessel Cushion A	DEC2852
29	Vessel Cushion B	DEC2853
30	Vessel Cushion C	DEC2854
31	Front Sheet	DED1132

9.5 EXTERIOR SECTION

1 2 3 4

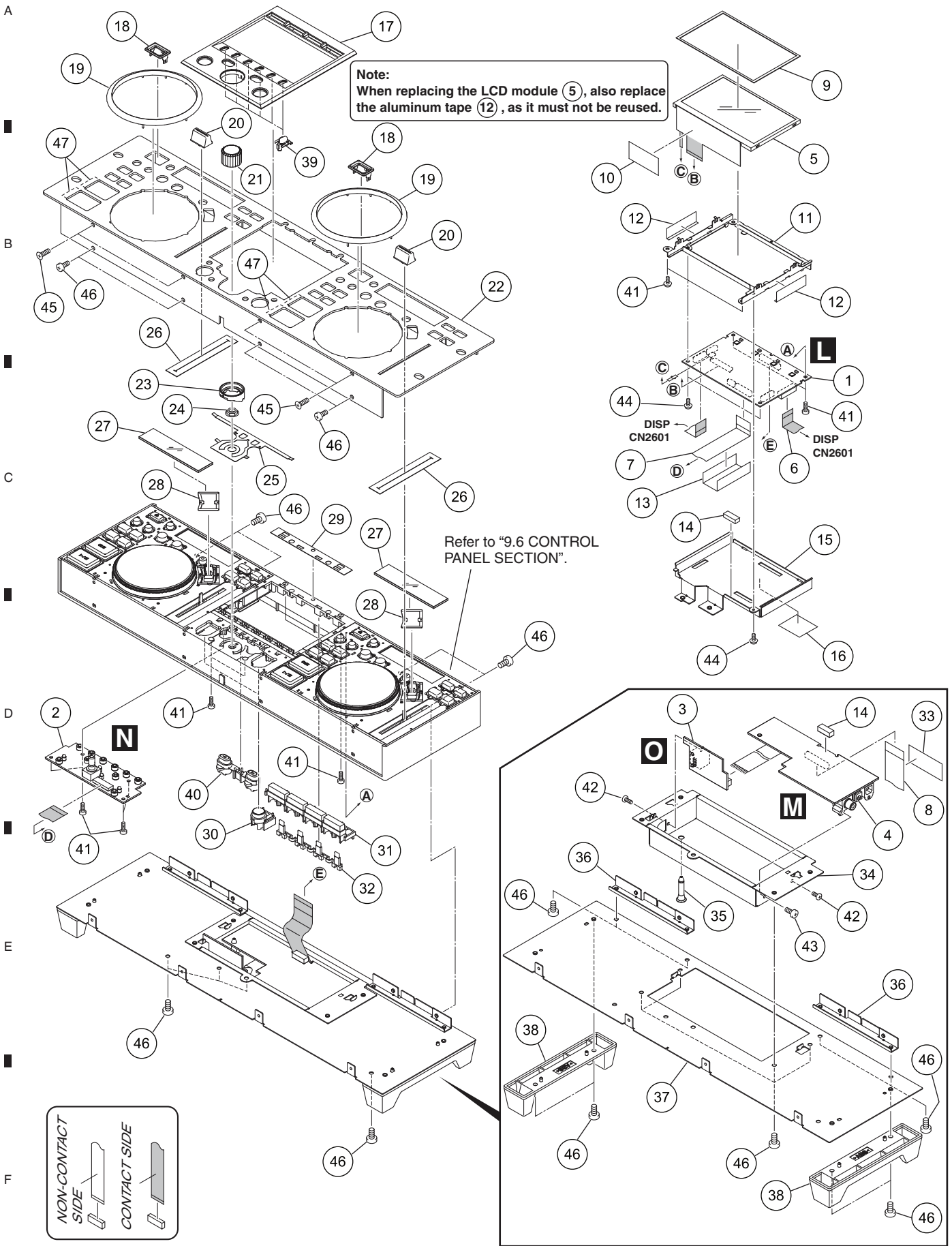

1 2 3 4

(1) EXTERIOR SECTION PARTS LIST

<u>Mark No.</u>	<u>Description</u>	<u>Part No.</u>	<u>Mark No.</u>	<u>Description</u>	<u>Part No.</u>
1	NMAIN Assy	DWX2705			
2	RENC Assy	DWS1399	26	Slide VR Packing	DED1157
3	DJACK Assy	DWX2788	27	OEL Panel	DAH2513
4	NJACK Assy	DWX2708	28	Earth Plate SC	DBK1313
5	LCD Module	DWX2754	29	Shade Sheet	DEC3064
			30	Load Knob	DNK4923
6	13P FFC	DDD1404			
7	18P FFC	DDD1405	31	Mode Knob	DNK4913
8	24P FFC	DDD1406	32	Mode Lens	DNK5036
9	TFT Cushion	DEC3003	33	EMC Sheet 20x55	DEC3096
10	Protection Tape	DEC3066	34	Jack Holder	DNH2795
			35	Locking Card Spacer	XEC3051
11	TFT Holder	DNH2791			
12	Aluminum Tape	DEF1019	36	Upper Bracket	DNH2809
13	EMC Sheet 45x45	DEC3095	37	Rear Panel	See Contrast table (2)
14	FFC Guard 6x16	DEC3065	38	Leg Assy	DXA2124
15	TFT Shield	DNH2792	39	Function Knob	DNK4922
			40	LR Knob	DNK4911
16	Guard Cushion	DEC3106			
17	Center Panel	DNK5244	41	Screw	BPZ20P080FTB
18	Eject Guard	DNK4920	42	Screw	DBA1340
19	Jog Ring	DNK4926	43	Screw	BPZ30P080FTC
20	Slide Knob	DNK4982	44	Screw	AMZ20P040FTC
			45	Screw	ABA7127
21	Dial Knob	DNK4924			
22	Control Panel	DNB1150	46	Screw	BBZ30P080FTB
23	Dial Lens	DNK4925	47	KNOB Cushion	DEC3131
24	Flange Nut M7	DBN1011			
25	Earth Plate F BLACK	DBK1323			

(2) CONTRAST TABLE

MEP-7000/KUCXJ, WYXJ5, TLFXJ and WAXJ5 are constructed the same except for the following:

Mark	No.	Symbol and Description	MEP-7000/KUCXJ	MEP-7000/WYXJ5	MEP-7000/TLFXJ	MEP-7000/WAXJ5
	37	Rear Panel	DNC1825	DNC1884	DNC1885	DNC1855

9.6 CONTROL PANEL SECTION

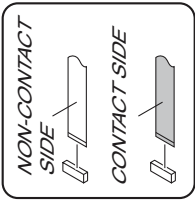

*1
Note :
 For details on how to apply grease,
 see "1.6 REASSEMBLING THE CONTROL UNIT" in this manual.

*2
Note :
 Be sure to place the convex surface of (12) toward (11).
 See "1.6 REASSEMBLING THE CONTROL UNIT" in this manual.

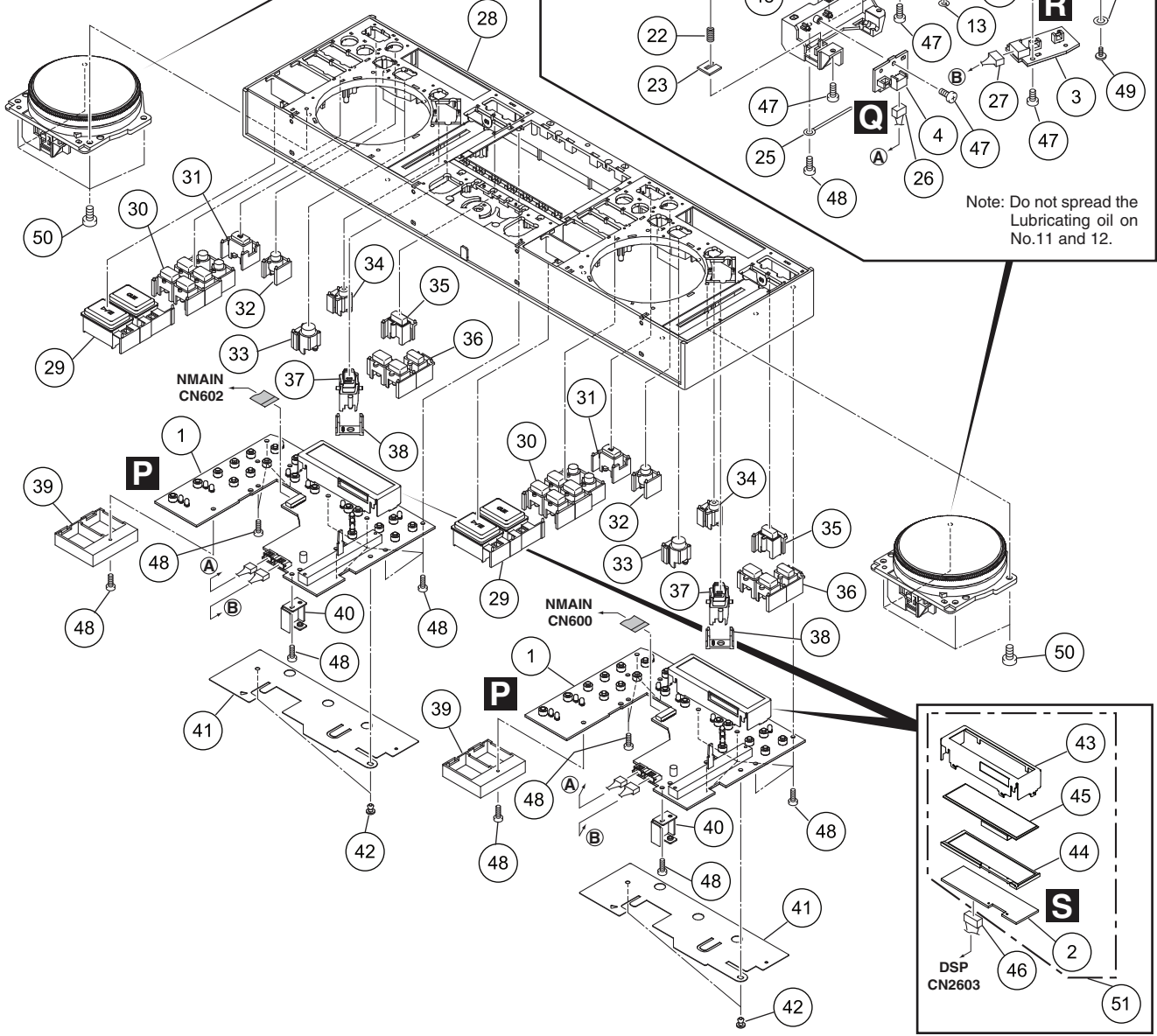
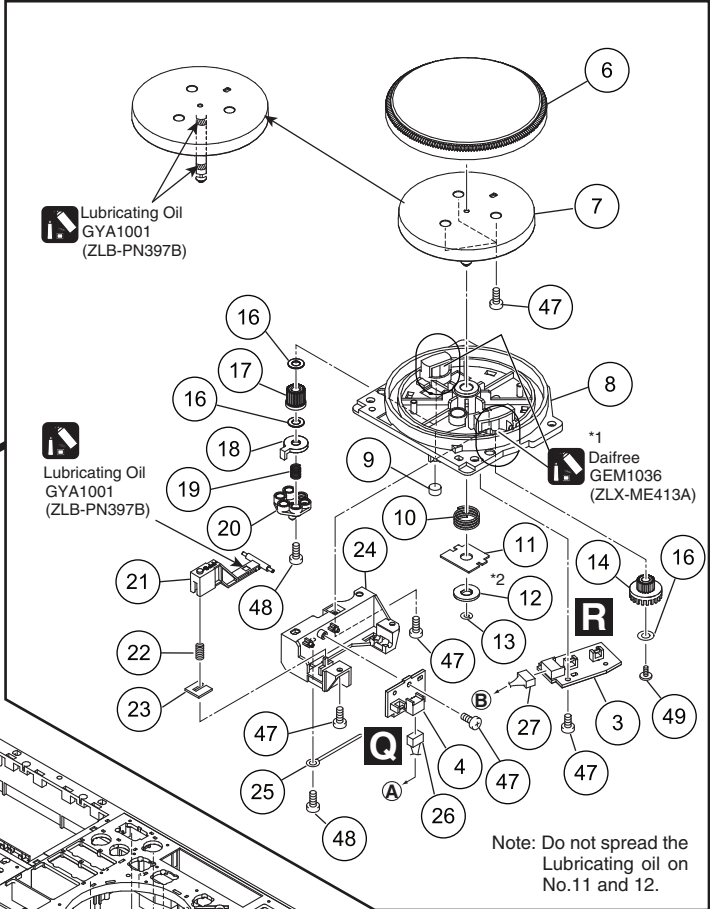

(1) CONTROL PANEL SECTION PARTS LIST

<u>Mark No.</u>	<u>Description</u>	<u>Part No.</u>	<u>Mark No.</u>	<u>Description</u>	<u>Part No.</u>	
1	DISP Assy	AWX2707	50	Screw	BPZ30P080FTC	
2	OELB Assy	DWX2714	51	OEL MODULE ASSY-S	DXX2590	A
3	JOGR Assy	DWX2709				
4	JOGT Assy	DWX2750				
5	•••••					
6	Jog Dial	DNK4759				
7	Jog Shaft	DNK4814				
8	Jog Holder Assy	DXA2118				
9	Lever Cushion (A)	DEC3001				
10	Jog Spring	DBH1588				
11	Jog Smoother Plate	DNK4897				B
12	Jog Smoother	DNK4815				
13	Washer	WT26D060D050				
14	Encoder Gear	DNK4764				
15	•••••					
16	Washer	WA41D070D025				
17	Load Gear (TW)	DNK5171				
18	Load Smoother	DNK4939				
19	Load Spring (TW)	DBH1659				
20	Adjust Plate	DNK4943				C
21	Jog Lever	DNK4763				
22	Lever Spring (TW)	DBH1589				
23	Lever Cushion (B)	DEC3002				
24	Lever Holder	DNK5206				
25	Cord Clamper	RNH-184				
26	Connector Assy 3P	PF03PP-B10				
27	Connector Assy 4P	PF04PP-B15				
28	Panel Base	DNK4907				
29	Play Knob	DNK4918				D
30	Search Knob	DNK4912				
31	Eject Knob	DNK4919				
32	Time Knob	DNK4921				
33	Loop Knob	DNK4915				
34	Reloop Knob	DNK4916				
35	Master Tempo Knob	DNK4914				
36	Pitch Bend Knob	DNK4910				
37	Scratch Knob	DNK4917				
38	Scratch Holder	DNK4930				E
39	PCB Support	DNK4928				
40	Earth Stay	DNH2794				
41	PCB Sheet	DEC3047				
42	Rivet	RBM-003				
NSP 43	OEL Stay	DNH2793				
NSP 44	OEL Holder	DNK4929				
NSP 45	OLED Unit	MXS8237				
46	Connector Assy 13P	DKP3795				F
47	Screw	BPZ20P060FTC				
48	Screw	BPZ20P080FTB				
49	Screw	DBA1265				

12. PCB PARTS LIST

NOTES: ● Parts marked by "NSP" are generally unavailable because they are not in our Master Spare Parts List.

● The Δ mark found on some component parts indicates the importance of the safety factor of the part. Therefore, when replacing, be sure to use parts of identical designation.

● When ordering resistors, first convert resistance values into code form as shown in the following examples.

Ex.1 When there are 2 effective digits (any digit apart from 0), such as 560 ohm and 47 k ohm (tolerance is shown by J = 5%, and K = 10%).

560 Ω \rightarrow 56 $\times 10^1$ \rightarrow 561RD1/APU $\boxed{5}$ $\boxed{6}$ $\boxed{7}$ J

47 k Ω \rightarrow 47 $\times 10^3$ \rightarrow 473RD1/APU $\boxed{4}$ $\boxed{7}$ $\boxed{3}$ J

0.5 Ω \rightarrow R50RN2H \boxed{R} $\boxed{5}$ $\boxed{0}$ K

1 Ω \rightarrow 1R0RSIP $\boxed{1}$ \boxed{R} $\boxed{0}$ K

Ex.2 When there are 3 effective digits (such as in high precision metal film resistors).

5.62 k Ω \rightarrow 562 $\times 10^1$ \rightarrow 5621RN1/4PC $\boxed{5}$ $\boxed{6}$ $\boxed{2}$ $\boxed{1}$ F

● Meaning of the figures and others in the parentheses in the parts list.

Example) IC 301 is on the point (face A, 91 of x-axis, and 111 of y-axis) of the corresponding PC board.

IC 301 (A, 91, 111) IC NJM2068V

Mark No.	Description	Part No.	Mark No.	Description	Part No.
----------	-------------	----------	----------	-------------	----------

LIST OF ASSEMBLIES

: CONTROL UNIT

	1..NMAIN ASSY	DWX2705
NSP	1..OELB ASSY (2 pair)	DWX2714
NSP	1..SIDE ASSY (2 pair)	DWM2300
	2..DISP ASSY	DWX2707
	2..JOGR ASSY	DWX2709
	2..JOGT ASSY	DWX2750
NSP	1..NSUB ASSY	DWM2298
	2..RENC ASSY	DWS1399
	2..NJACK ASSY	DWX2708
	2..DJACK ASSY	DWX2788

: DRIVE UNIT

	1..SMAIN ASSY	DWX2706
NSP	1..SERVO ASSY	DWM2297
	2..SRV1 ASSY	DWX2711
	2..SRV2 ASSY	DWX2712
NSP	1..SSUB ASSY (KUCXJ)	DWM2332
NSP	1..SSUB ASSY (WYXJ5, TLFXJ, WAXJ5)	DWM2333
	2..ACIN ASSY (KUCXJ)	DWR1438
	2..ACIN ASSY (WYXJ5, TLFXJ, WAXJ5)	DWR1439
	2..FSWB ASSY	DWS1400
	2..SLMB1 ASSY	DWS1401
	2..SLMB2 ASSY	DWS1402
	2..EJTB ASSY	DWS1403
	2..SJACK ASSY	DWX2896
	2..USBB ASSY	DWX2713

Δ 1..POWER SUPPLY UNIT DWR1440

Mark No.	Description	Part No.
----------	-------------	----------

A SMAIN ASSY

SEMICONDUCTORS

	IC 200	BU4230G
	IC 201	TC74LCX08FTS1
	IC 202	ADSP-BF531SBSTZ400
	IC 203	TC7SZ08FU
Δ IC	204,305,503	BD00KA5WFP
	IC 205	DYW1768
	IC 206,207	K4S560832H-UC75
	IC 208	TC74LCX32FTS1

280

IC	209	TC7SZ04FU
IC	300,302	TC7SH08FUS1
IC	301	XC3S50-4TQG144C
IC	303,306	TC74VHC04FTS1
Δ IC	304	BH25FB1WG
IC	351-354	TC74LCX574FTS1
Δ IC	356	BA33DD0WHFP
IC	357,559	TC7SH04FUS1
IC	400,504	TC7WHU04FU
IC	401	TC74VHC163FT
IC	402	TDOTG242-0F0C8
IC	403	USB2504A-JT
Δ IC	404,405	R5523N001B
IC	501	DSPC56371AF180
IC	505	TC7WH08FU
IC	506,507	PE8001A
Δ IC	555	NJM78M05DL1A
IC	558	TC7SZU04FU
IC	560	TC7SET08FUS1
Q	202,354,355	RT1N241M
Q	350-353	2SC4154
Q	500-503	2SD2114K
Q	552,553	2SC2412K
D	201,202	SML-310VT
D	598,599	1SS352
D	600,601	HZM6R2ZMWA

MISCELLANEOUS

L	301,302 CHIP FERRIT BEADS	DTL1176
L	401-403 COIL	DTH1197
L	404-408 CHIP COIL	OTL1009
Δ L	409 CHIP FERRITE BEADS	VTL1169
KN	361-366 EARTH METAL FITTING	VNF1109

X	200 CRYSTAL RESONATOR	XSS3003
X	400 CRYSTAL RESONATOR (24 MHz)	BSS1121
X	500 CRYSTAL RESONATOR (16.9344 MHz)	VSS1084
CN	200 10P CONNECTOR	VKN1414
CN	300,302 CONNECTOR	CKS5054
CN	301 CONNECTOR	CKS4187
CN	350 CONNECTOR	VKN1948
CN	351 CONNECTOR	AKM1299
CN	352,353 CONNECTOR	AKM1291
CN	400 CONNECTOR	AKM1290

Mark	No.	Description	Part No.
	CN 401	CONNECTOR	AKM1294
	CN 500	CONNECTOR	AKM1293
	CN 501	CONNECTOR	AKM1289
△	P 101	PROTECTOR(1.000A)	DEK1097
△	P 102	PROTECTOR(1.750A)	DEK1100
△	P 103-106	PROTECTOR(1.250A)	DEK1098

RESISTORS

R	247,251,255	RAB4CQ100J
R	252,266,381,385	RS1/16SOR0J
R	260,399,522	RS1/16SS3302F
R	261,1300	RS1/16SS5602F
R	267-270	RAB4CQ100J
R	278-281,284,288	RAB4CQ470J
R	282,294,295,300	RAB4CQ220J
R	290,293,296-298	RAB4CQ470J
R	301,319,323,1205	RAB4CQ220J
R	302,303,407,408	RAB4CQ470J
R	386,545-550,1583	RS1/16SOR0J
R	388,391,395,396	RS1/16S220J
R	390,392-394	RS1/16S331J
R	410,412-415,1204	RAB4CQ470J
R	442	RS1/16SS1202F
R	521	RS1/16SS2202F
R	535	RAB4CQ103J
R	1301,1303,1314-1324	RS1/16S220J
R	1310-1313,1325-1328	RAB4C220J
R	1329-1339	RS1/16S220J
R	1380,1592	RS1/4SA0R0J
R	1587,1593,1595	RS1/16SOR0J
	Other Resistors	RS1/16SS###J

CAPACITORS

C	200,207-211	CKSSYB104K10
C	201,205	CCSSCH8R0D50
C	202,300-307,310	CKSSYB103K16
C	213-226,228-233	CKSSYB104K10
C	227,253-256	BCG1054
C	234,334	CEVW101M6R3
C	235-252,257,309	CKSSYB104K10
C	311,313-323,326	CKSSYB103K16
C	324,327,329,332	CKSSYB104K10
C	325,372,374	DCH1201
C	330,386-388	CCSRCH102J50
C	333,427,528,1400	CKSSYB103K16
C	335,336,351-354	CKSSYB104K10
C	337-339,367-369	BCG1054
C	356-358,375,376	CKSSYB104K10
C	359,1405,1406	CEHVW101M6R3
C	360,390,551,554	CEVW101M16
C	361-366,535-540	CKSRYB104K16
C	371,378,415,421	BCG1054
C	379,402-414,416	CKSSYB104K10
C	391-399	CCSSCH471J16
C	400,401	CCSSCH9R0D50
C	418-420,422,425	CKSSYB104K10
C	423,424,429	BCG1054
C	426,428,431-434	CKSSYB104K10
C	435,436,541-544	CEVW470M16
C	502,505-507	CKSSYB104K10

Mark	No.	Description	Part No.
C	512-519,521-523	CKSSYB104K10	
C	520,529,530	CEVW101M10	
C	524,525	CCSSCH180J50	
C	526,527,552,553	CKSSYB104K10	
C	531,532,567,1404	CEVW470M6R3	
C	549,550	CKSRYB104K16	
C	565,566,1401,1402	CKSSYB104K10	
C	701-710	CCSSCH101J50	
C	711-720	CKSSYB102K50	
C	1391-1399	CCSRCH221J50	
C	1403	CEVW101M16	

B EJT B ASSY**SEMICONDUCTORS**

Q	4200,4201	RT1N241M
D	4200-4202	SLI-343P8C(ABCD)

MISCELLANEOUS

S	4200,4201 SWITCH	VSG1024
CN	4200 PLUG(10P)	KM200NA10LE
CN	4201 CONNECTOR	SLW6R-1C7

RESISTORS

All Resistors	RS1/16S###J
---------------	-------------

C FSWB ASSY**SEMICONDUCTORS**

Q	4100,4101	RT1N241M
D	4100,4101	SLI-343U8RC(HJKL)

MISCELLANEOUS

S	4100,4101 SWITCH	VSG1024
CN	4100 CONNECTOR	SLW6R-1C7

RESISTORS

All Resistors	RS1/16S###J
---------------	-------------

D SJACK ASSY**SEMICONDUCTORS**

IC	10,11	NJM4580D
△ IC	12	NJM7815FA
△ IC	13	NJM7915FA
Q	10,12	RT1P241M
Q	11,13	RT1N241M
Q	14-21	2SD2114K
△ Q	24	2SD2114K(VW)
D	12-15,20	HZM6R2ZMWA
D	16-19	1SS352
D	21	UDZS12(B)

MISCELLANEOUS

L	10,11 CHIP SOLID INDUCTOR	XTL3010
L	12,13 FERRITE CORE	VTF1090
JA	10,11 JACK	VKB1243
JA	12 2P PIN JACK	DKB1085
JA	13 10P MIN DIN SOCKET	DKP3788
JA	14 PIN JACK(4P)	DKB1090
JA	15 USB CONNECTOR	BKP1164
JA	16 USB CONNECTOR	DKN1237
KN	10,11 WRAPPING TERMINAL	VNF1084

Mark	No.	Description	Part No.	Mark	No.	Description	Part No.
	CN 10	20P CONNECTOR	VKN1251	KN	105,106	EARTH METAL FITTING	VNF1109
A	CN 11	PLUG(8P)	KM200NA8	X	100	CERAMIC RESONATOR (16.934 MHZ)	DSS1157
	CN 15	PLUG(7P)	KM200NA7	CN	100	24P FFC CONNECTOR	DKN1445
	CN 16	PLUG(4P)	KM200NA4E	CN	101	CONNECTOR	VKN1935
	CN 17	PLUG(3P)	KM200NA3				
	JH 2,3	PCB BINDER	VEF1040	CN	103	CONNECTOR	CKS4179
	△ P 10,11	PROTECTOR(500MA)	AEK7005	CN	104	CONNECTOR	CKS4868
	VA	12,13 VARISTORS	EZJZ1V270RM	CN	107	CONNECTOR	AKM1276
				CN	108	CONNECTOR	AKM1277

RESISTORS

R	18,20	RS2LMF222J
R	41-44,81-84	RS1/10S473J
R	47,48,51,52	RS1/10S471J
R	61	RS1/10S472J
R	62	RS1/10S101J
R	65-70,73,74	RS1/10S152J
R	71,72,75,76	RS1/10S103J
R	77-80	RS1/10S113J
R	89-96	RS1/10S471J
	Other Resistors	RS1/16S###J

CAPACITORS

C	12	CEJQ101M16
C	13,15-17,35	CKSRYB104K16
C	14,54	CKSRYB105K10
C	19-22,43-46	DCH1283
C	23-26,31-34	CQMBA471J50
C	27-30	CQMBA561J50
C	36,38,39,41	DCH1282
C	37,40,42,47	CKSRYB104K16
C	48,63,72,73	CKSRYB104K16
C	49-52	CQMBA102J50
C	53	CCSRCH151J50
C	55,56	CKSRYB104K50
C	57-60	CEAT100M50
C	64,78-81,83	CKSRYB102K50
C	65	CKSRYB103K50
C	74-77	CKSRYB471K50
C	82,84	CCSRCH471J50
C	85	CKSYB106K16

E SRV1 ASSY

SEMICONDUCTORS

△ IC	100	BD7956FS
△ IC	101	MM1478DFBE
IC	102	AN22022A
△ IC	103	BD00KA5WFP
IC	104	DYW1769
△ IC	105	NJM2880U1-05
IC	106	MN103S71F
IC	108	NJU7016M
△ IC	109	PQ200WNA1ZPH
IC	110	TC7W53FU
Q	100,101	RT1N144M
Q	102,103	2SA1036K(PQR)
Q	104	HN1B04FU
Q	105	UM5K1N
D	101	RB060L-40

MISCELLANEOUS

L	101,102	CHIP COIL	Otl1009
---	---------	-----------	---------

RESISTORS

R	126,131,169,1139	RS1/16S1002F
R	127,130	RS1/16S3302F
R	133,176	RS1/16S4701F
R	143	RAB4CQ103J
R	157	RS1/16SS1502F
R	167,1133,1134	RS1/16S2702F
R	171-175,177-199	RS1/16S220J
R	1100-1114	RS1/16S220J
R	1115-1118,1147,1148	RS1/16SS3303F
R	1122,1123	RS1/4SA3R3J
R	1126-1129	RS1/4SA1R0J
R	1137,1138	RS1/16SOR0J
R	1140	RS1/16S1002F
	Other Resistors	RS1/16SS###J

CAPACITORS

C	101,103,114,150	CKSSYB103K16
C	102,106-108,112	CKSSYB104K10
C	104,105,122,124	CEVW470M16
C	110	DCH1275
C	111,140,1116,1120	CEHVW470M16
C	113,116,149,155	CKSRYB105K10
C	115,123	CCH1426
C	117	DCH1200
C	118-121,126,132	CKSSYB104K10
C	125,127	CCSRCH221J50
C	128,134,1118,1119	CEVW470M16
C	129	CKSSYB561K50
C	130,170	CKSSYB273K10
C	131	CKSSYB473K10
C	133,135,136,138	CKSSYB104K10
C	137,159,172,176	CKSSYB102K50
C	139	CCSSCH151J50
C	141,143-147,151	CKSSYB104K10
C	152,160,162,164	CKSSYB104K10
C	153,154	CKSSYB471K50
C	156,158	CKSSYB182K50
C	157	CKSSYB222K50
C	161,177,184,185	CKSSYB103K16
C	163	CKSSYB122K50
C	165,175	CKSRYB105K10
C	166,171,173,174	CKSSYB104K10
C	167,168	CKSRYB102K50
C	169,1107	CCSSCH101J50
C	178-181,186-188	CKSSYB104K10
C	182	CKSRYB333K16
C	183	CKSRYB473K50
C	191,1103-1105,1114	CKSSYB103K16
C	196,197,1108,1109	CKSSYB104K10
C	1102	CCSRCH470J50
C	1106	CKSRYB224K10

Mark	No.	Description	Part No.	Mark	No.	Description	Part No.
C	1110,1111		CCSRCH102J50	R	926,931,969,1939		RS1/16S1002F
C	1112,1113,1122-1125		CKSSYB104K10	R	927,930		RS1/16S3302F
C	1115		CKSSYB103K16	R	933,976		RS1/16S4701F
C	1117		CKSSYB333K10	R	943		RAB4CQ103J
C	1121		CEHVW470M16	R	957		RS1/16SS1502F
C	1126		BCG1054	R	967,1933,1934		RS1/16S2702F
				R	971-975,977-999		RS1/16S220J
				R	1900-1914		RS1/16S220J
				R	1915-1918,1947,1948		RS1/16SS3303F
				R	1922,1923		RS1/4SA3R3J
				R	1926-1929		RS1/4SA1R0J
				R	1937,1938		RS1/16S0R0J
				R	1940		RS1/16S1002F
				Other Resistors			RS1/16SS###J
F SLMB1 ASSY							
MISCELLANEOUS							
S	4400,4401	PUSH SWITCH	DSG1017				
CN	4400	CONNECTOR	SLW4R-1C7				
CN	4401	PLUG(9P)	KM200NA9LE				
CN	4402	L-PLUG(3P)	KM200NA3L				
G USBB ASSY							
SEMICONDUCTORS							
D	4300,4301		HZM6R2ZMWA				
MISCELLANEOUS							
JA	4301	USB CONNECTOR	VKB1248				
KN	4300	WRAPPING TERMINAL	VNF1084				
CN	4300	L-PLUG(4P)	KM200NA4L				
RESISTORS							
		All Resistors	RS1/16S###J				
CAPACITORS							
C	4301		CEJQ101M16				
C	4303		CKSRYB105K10				
H SRV2 ASSY							
SEMICONDUCTORS							
△ IC	900		BD7956FS				
△ IC	901		MM1478DFBE				
IC	902		AN22022A				
△ IC	903		BD00KA5WFP				
IC	904		DYW1769				
△ IC	905		NJM2880U1-05				
IC	906		MN103S71F				
IC	908		NJU7016M				
△ IC	909		PQ200WNA1ZPH				
IC	910		TC7W53FU				
Q	900,901		RT1N144M				
Q	902,903		2SA1036K(PQR)				
Q	904		HN1B04FU				
Q	905		UM5K1N				
D	901		RB060L-40				
MISCELLANEOUS							
L	901,902	CHIP COIL	OTL1009				
KN	905,906	EARTH METAL FITTING	VNF1109				
X	900	CERAMIC RESONATOR (16.934 MHz)	DSS1157				
CN	900	24P FFC CONNECTOR	DKN1445				
CN	901	CONNECTOR	VKN1935				
CN	903	CONNECTOR	CKS4179				
CN	904	CONNECTOR	CKS4868				
CN	907	CONNECTOR	AKM1276				
CN	908	CONNECTOR	AKM1277				
RESISTORS							
				I SLMB2 ASSY			
				R	926,931,969,1939		RS1/16S1002F
				R	927,930		RS1/16S3302F
				R	933,976		RS1/16S4701F
				R	943		RAB4CQ103J
				R	957		RS1/16SS1502F
				R	967,1933,1934		RS1/16S2702F
				R	971-975,977-999		RS1/16S220J
				R	1900-1914		RS1/16S220J
				R	1915-1918,1947,1948		RS1/16SS3303F
				R	1922,1923		RS1/4SA3R3J
				R	1926-1929		RS1/4SA1R0J
				R	1937,1938		RS1/16S0R0J
				R	1940		RS1/16S1002F
				Other Resistors			RS1/16SS###J
				CAPACITORS			
				C	901,903,914,950		CKSSYB103K16
				C	902,906-908,912		CKSSYB104K10
				C	904,905,922,924		CEVW470M16
				C	910		DCH1275
				C	911,940,1916,1920		CEHVW470M16
				C	913,916,949,955		CKSRYB105K10
				C	915,923		CCH1426
				C	917		DCH1200
				C	918-921,926,932		CKSSYB104K10
				C	925,927		CCSRCH221J50
				C	928,934,1918,1919		CEVW470M16
				C	929		CKSSYB561K50
				C	930,970		CKSSYB273K10
				C	931		CKSSYB473K10
				C	933,935,936,938		CKSSYB104K10
				C	937,959,972,976		CKSSYB102K50
				C	939		CCSSCH151J50
				C	941,943-947,951		CKSSYB104K10
				C	952,960,962,964		CKSSYB104K10
				C	953,954		CKSSYB471K50
				C	956,958		CKSSYB182K50
				C	957		CKSSYB222K50
				C	961,977,984,985		CKSSYB103K16
				C	963		CKSSYB122K50
				C	965,975		CKSRYB105K10
				C	966,971,973,974		CKSSYB104K10
				C	967,968		CKSRYB102K50
				C	969,1907		CCSSCH101J50
				C	978-981,986-988		CKSSYB104K10
				C	982		CKSRYB333K16
				C	983		CKSRYB473K50
				C	991,1903-1905,1914		CKSSYB103K16
				C	996,997,1908,1909		CKSSYB104K10
				C	1902		CCSRCH470J50
				C	1906		CKSRYB224K10
				C	1910,1911		CCSRCH102J50
				C	1912,1913,1922-1925		CKSSYB104K10
				C	1915		CKSSYB103K16
				C	1917		CKSSYB333K10
				C	1921		CEHVW470M16
				C	1926		BCG1054

Mark No. Description Part No.**MISCELLANEOUS**

S	4500,4501 PUSH SWITCH	DSG1017
CN	4500 CONNECTOR	SLW4R-1C7
CN	4501 PLUG(9P)	KM200NA9LE
CN	4502 L-PLUG(3P)	KM200NA3L

Mark No. Description Part No.

△ Q	814	RSQ035N03
Q	1600	2SA1576A
D	601,602	SML-310VT
D	700,811,817	RB160M-40
D	800-803	SML-212VT(QR)
D	804,809,813,816	1SS352
D	806,808	RSX201L-30
D	815	RB161M-20
D	1600	DAN217

J POWER SUPPLY UNIT

POWER SUPPLY UNIT has no service part.

K ACIN ASSY (KUCXJ)**MISCELLANEOUS**

△ AN	1 AC INLET 1P	XKP3042
△ J	1 CONNECTOR ASSY2P	DKP3780
△ S	1 SWITCH	DSA1033

MISCELLANEOUS

L	700 INDUCTOR	DTH1204
L	701 COIL	DTH1197
L	801 INDUCTOR	BTH1112
L	802 INDUCTOR	DTL1137
L	804,806 POWER INDUCTOR(22U)	DTL1100
△ L	805 INDUCTOR	BTH1110
L	1600 INDUCTOR	LCTC1R8K2125
L	1601 INDUCTOR	LCTC1R0K2125
L	1602 CHIP FERRITE BEADS	DTF1117
L	1603 CHIP FERRITE BEADS	VTL1169

CAPACITORS

△ C	1	ACG7033
-----	---	---------

S	800-803 SWITCH	VSG1020
X	600 CRYSTAL RESONATOR	XSS3003
X	700 CRYSTAL RESONATOR (9 MHz)	DSS1164
X	701 CRYSTAL RESONATOR (6 MHz)	DSS1136
X	1600 CRYSTAL RESONATOR	VSS1172

K ACIN ASSY (WYXJ5, TLFXJ, WAXJ5)**MISCELLANEOUS**

△ AN	1 AC INLET 1P	XKP3041
△ J	1 CONNECTOR ASSY2P	DKP3780
△ S	1 SWITCH	DSA1033

CAPACITORS

△ C	1	ACG7033
-----	---	---------

CN	600,602 13P CONNECTOR	VKN1417
CN	601 10P CONNECTOR	VKN1414
CN	700 4P FPC CONNECTOR	DKN1488
CN	701 40P FPC CONNECTOR	DKN1487
CN	702 24P CONNECTOR	VKN1428
CN	800 18P CONNECTOR	VKN1422
CN	1700 6P CONNECTOR	VKN1410

L NMAIN ASSY**SEMICONDUCTORS**

IC	600	BU4242G
IC	601	ADSP-BF531SBSTZ400
IC	603	TC74VHCT08AFTS1
IC	604	TC74VHC08FTS1
IC	605	TC7SET04FUS1
IC	606,808	TC7SET08FUS1
IC	609	DYW1767
IC	610	K4S2816321-UC75
△ IC	611	BD00KA5WFP
△ IC	700	BD6067GU
IC	701	TC7WHU04FU
IC	702,703	TC74VHC541FTS1
IC	705	TC7WH08FU
IC	706	TD0TG242-0F0C8
IC	800	PEG481A
△ IC	802	BD9305AFVM
△ IC	803	BH25FB1WG
△ IC	807	BD8152FVM
△ IC	809	BD9306AFVM
△ IC	810	R1232D331A

RESISTORS

R	636,643,648,660	RAB4CQ220J
R	649,650,661	RAB4CQ330J
R	651,652	RAB4CQ470J
R	662,663,666,812	RAB4CQ220J
R	681	RS1/16SS3302F
R	682	RS1/16SS5602F
R	804-806,860	RAB4CQ473J
R	822	RS1/16S1202F
R	826	RS1/16S3902F
R	880	RN1/16SE1002D
R	881	RN1/16SE3002D
R	886	RS1/4SA271J
R	887	RS1/4SA241J
R	1602,1665	RS1/16S75R0F
R	1603	RS1/16S2201D
Other Resistors		RS1/16S###J

CAPACITORS

C	600,601,603	CKSRYB104K16
C	602,823,862	CKSRYB103K50
C	604,615,616,646	CCG1192
C	605,606,703,705	CCSSCH8R0D50
C	609-614,617-627	CKSRYB104K16
C	628,629	CCSSCH221J50
C	630-645,647-649	CKSRYB104K16
C	650,712,817,824	CCG1192

IC	811	BU4230G
IC	1600	S1D13746B01B
△ IC	1601	BH30MA3WHFV
△ IC	1602	BH15LB1WG
IC	1603	NJM2561F1

IC	1700	PDY084A8
Q	601,800-803	RT1N241M
△ Q	805,806,811	RTQ040P02
Q	807,812	RT1N144M

Mark	No.	Description	Part No.
C	651,654,661-663		CKSRYB104K16
C	660,664		BCG1054
C	700,701,803,832		CKSRYB105K10
C	702		BCG1064
C	704,706-711,714		CKSRYB104K16
C	713,716		CCSSCH220J50
C	715,717-727		CKSRYB104K16
C	800-802,804,806		CKSRYB104K16
C	807,812,815,825		CKSRYB104K16
C	809,864		CCSRCH221J50
C	810		CKSRYB474K16
C	814		CCSSCH101J50
C	829,831,837		CCG1192
C	835		CKSRYB332K50
C	836,866,873-875		CKSRYB104K16
C	839		CKSYB106K16
C	853,855,857,859		CKSRYB102K50
C	865,1602		CCSRCH101J50
C	867-869,871,872		CCG1192
C	876,1605,1610		CKSRYB105K10
C	1600,1601		CCSSCH8ROD50
C	1604		CCSRCH271J50
C	1606-1608,1618,1625		CCG1192
C	1609,1611,1612		CKSRYB104K16
C	1614-1617,1619,1621		CKSRYB104K16
C	1622,1624,1636		CKSRYB104K16
C	1626		CCSRCH330J50
C	1627		CCSRCH220J50
C	1634,1635		CCG1192
C	1640-1642,1700-1703		CKSRYB104K16
C	1705		CKSRYB104K16

M NJACK ASSY

SEMICONDUCTORS

△ IC	2200	BA33BCOWFP
IC	2201-2203,2206,2207	TC7WH04FU
IC	2204	NJM2903M
△ Q	2201,2202	RTQ040P02
Q	2203-2206	RT1N144M
D	2204-2207	HZM6R2ZMWA
D	2208-2215	1SS352

MISCELLANEOUS

L	1,3	CHIP FERRIT BEADS	DTL1177
L	2,4	CHIP FERRIT BEADS	DTL1176
JA	2200	PIN JACK(1P)	AKB7175
JA	2201	DCIN JACK	DKN1523
CN	2201	CONNECTOR	SLW24S-1C7
CN	2202	USB CONNECTOR	DKN1237
JH	2203	10P CABLE HOLDER	51048-1000
JP	2203	JUMPER WIRE	D20PYY1010E
VA	2200,2201	VARISTORS	EZJZ1V270RM

RESISTORS

R	2252-2255,2257-2260	RS1/16S2701D
R	2303	RS1/16S75R0F
	Other Resistors	RS1/16S###J

CAPACITORS

C	2201,2202,2205,2206	CKSRYB104K16
C	2203,2225,2234,2238	CKSRYB103K50

Mark	No.	Description	Part No.
C	2204		BCG1054
C	2207		CKSYB106K16
C	2213,2215,2218,2240		CKSRYB104K16
C	2216		CEAT102M16
C	2222		CEAT102M10
C	2223,2226,2229,2232		CCSRCH101J50
C	2224,2227,2230,2233		CKSRYB102K50
C	2228,2231,2267,2287		CCSRCH221J50
C	2235,2257,2262,2263		CKSRYB102K50
C	2239,2241-2244		CKSRYB103K50
C	2245,2283,2284		CKSRYB104K16
C	2258,2269,2274,2289		CCSRCH101J50
C	2266,2291,2292		CCG1203
C	2268,2280,2281,2285		CKSRYB102K50
C	2271		CCSRCH102J50
C	2288		CKSRYB102K50
C	2293		CKSRYB105K10

N RENC ASSY

SEMICONDUCTORS

Q	2100-2102	RT1N241M
D	2100-2104	SLR343BC4T(JKLM)

MISCELLANEOUS

S	2100,2101,2109,2110	SWITCH	VSG1024
S	2102-2106,2108	TACT SWITCH	DSG1079
S	2107	JOG SWITCH	DSX1056
CN	2100	CONNECTOR	CKS3832

RESISTORS

	All Resistors	RS1/16S###J
--	---------------	-------------

CAPACITORS

C	2100	CKSRYB104K16
---	------	--------------

O DJACK ASSY

SEMICONDUCTORS

D	2400-2402	HZM6R2ZMWA
---	-----------	------------

MISCELLANEOUS

JA	2400	10P MIN DIN SOCKET	DKP3788
CN	2400	10PJUMPER CONNECTOR	52147-1010

RESISTORS

	All Resistors	RS1/16S###J
--	---------------	-------------

CAPACITORS

C	2406	CCSRCH471J50
C	2407	CKSRYB102K50
C	2408	CKSRYB103K50
C	2409	CKSYB106K16

P DISP ASSY

SEMICONDUCTORS

IC	2600	PEG480A
IC	2601	TC7W14FU
Q	2601-2605,2609-2611	RT1N241M
Q	2606-2608	2SA1162
D	2604,2622-2625,2628	1SS352
D	2606,2610,2611,2616	SLI-343Y8C(KLMN)

Mark	No.	Description	Part No.
A	D	2609	UW3804(ABCDEF)
	D	2612	SLI-580P4T(LMNP)
	D	2613,2614	SLR343EC4T(LMN)
	D	2615	SLR343BC4T(JKLM)
	D	2618	SLI-343U8RC(HJKL)
D	2619,2621	SLI-343Y8C(KLMN)	
D	2629	1SS352	

Mark	No.	Description	Part No.
S OELB ASSY			
SEMICONDUCTORS			
	△ Q	2300	2SC4617
	△ Q	2301	2SC2411K
	TH	2300	CCX1037

MISCELLANEOUS

L	2600,2601	CHIP COIL	DTL1180
VR	2600	VARIABLE RESISTOR	DCV1011
S	2600-2611,2617,2618	SWITCH	VSG1024
S	2612,2613	TACT SWITCH	DSG1117
S	2614-2616	TACT SWITCH	DSG1079

MISCELLANEOUS

CN	2300	CONNECTOR	VKN1939
----	------	-----------	---------

RESISTORS

R	2303		RN1/16SE2202D
R	2306		RN1/16SE3002D
	Other Resistors		RS1/16S###J

CAPACITORS

C	2300		CKSQYF334Z25
C	2301		CCG1192
C	2305,2306		CKSQYF104Z25
C	2310		CKSRYB471K50
C	2311		CKSRYB104K16

RESISTORS

R	2601,2684		RS1/16S2201F
	Other Resistors		RS1/16S###J

CAPACITORS

C	2603,2620,2623,2625		CKSRYB104K16
C	2604		CEAL101M10
C	2605-2611,2615-2617		CCSRCH101J50
C	2618,2619,2621,2637		CKSRYB102K50
C	2622,2624		CCSRCH180J50

C	2313		CKSRYB224K10
C	2316		CKSQYB105K16
C	2318-2320,2322		CCSRCH330J50
C	2321		CKSRYB103K50

C	2630-2632		CCSRCH221J50
C	2634-2636		CKSRYB104K16
C	2638		CKSRYB102K50
C	2639		CEAL100M16
C	2640		CEAL330M10

Q JOGT ASSY**SEMICONDUCTORS**

IC	2800		GP1S94
Q	2800		2SC4154

MISCELLANEOUS

CN	2800	L-PLUG(3P)	KM200NA3L
----	------	------------	-----------

RESISTORS

	All Resistors		RS1/16S###J
--	---------------	--	-------------

CAPACITORS

C	2801		CKSRYB104K16
---	------	--	--------------

R JOGR ASSY**SEMICONDUCTORS**

IC	2700,2701		GP1S94
Q	2700,2701		2SC4154

MISCELLANEOUS

CN	2700	L-PLUG(4P)	KM200NA4L
----	------	------------	-----------

RESISTORS

	All Resistors		RS1/16S###J
--	---------------	--	-------------

CAPACITORS

C	2702		CKSRYB104K16
---	------	--	--------------