

## EXPLODED VIEW (CD MECHANISM)

- A : N09-6108-15
- B : N09-6426-15+
- C : N09-6735-05
- D : N09-6737-15
- E : N09-6738-15
- F : N19-2335-14
- G : N35-2003-48
- H : N39-1720-48

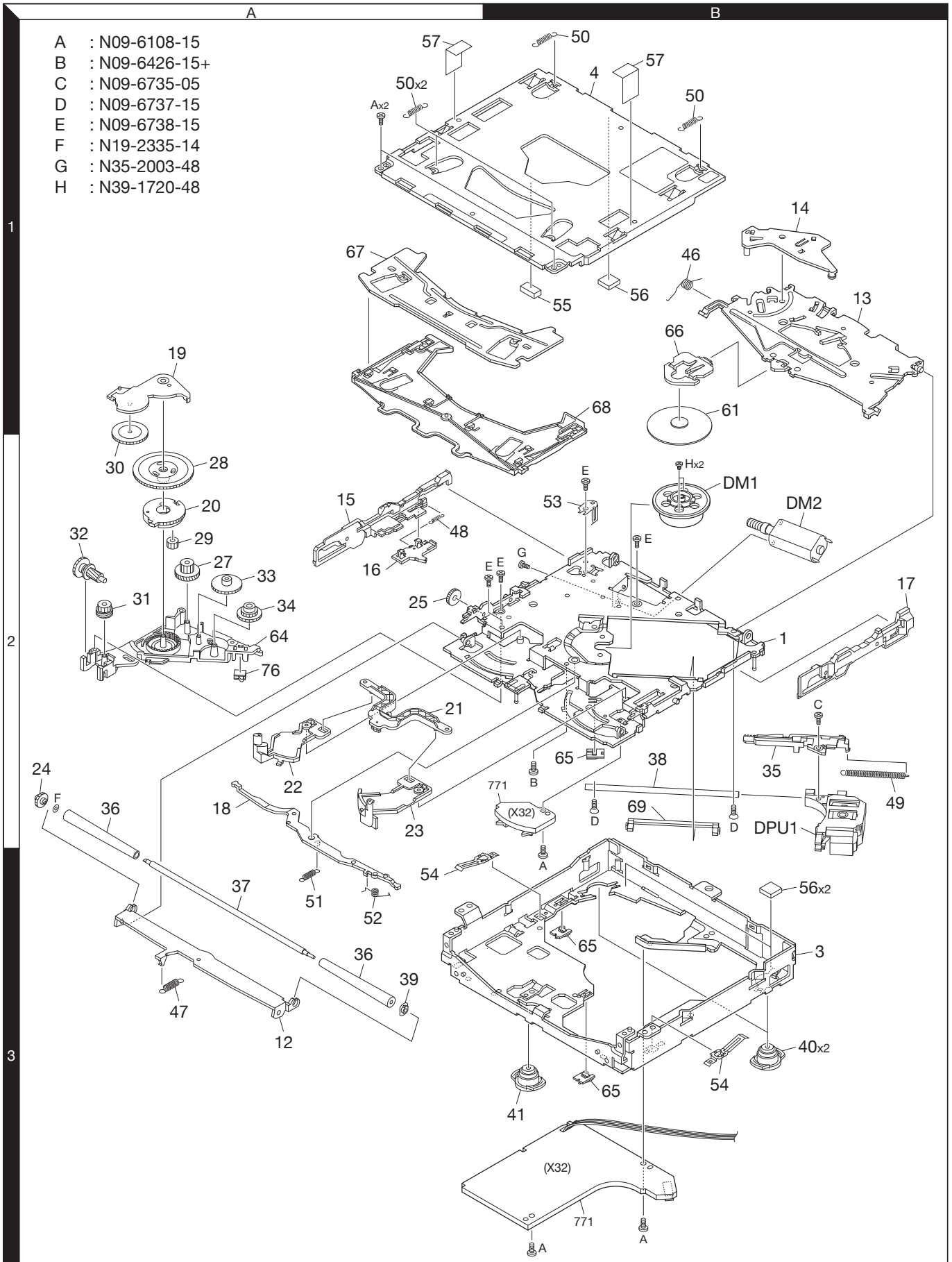

Parts with the exploded numbers larger than 700 are not supplied.



## PARTS LIST

\* New parts

Parts without **Parts No.** are not supplied.

Les articles non mentionnés dans le **Parts No.** ne sont pas fournis.

Teile ohne **Parts No.** werden nicht geliefert.

Ref. No.	A d d	N e w	Parts No.	Description	Desti- nation
<b>KDC-HD942U</b>					
203	2C	*	A22-3218-02	SUB PANEL ASSY	
205	3D	*	A40-1365-02	BOTTOM PLATE	
206	2C	*	A46-1890-01	REAR COVER	
207	1D	*	A52-1111-01	TOP COVER	
PA1	3C	*	A64-4777-01	PANEL ASSY	
RC1	1C		A70-2085-15	REMOTE CONTROLLER ASSY (RC-547)	
-		*	B64-4416-00	INST. MANUAL (ENGLISH)	
-		*	B64-4417-00	INST. MANUAL (FRE.SPA.)	
211	1C		B07-3235-03	ESCUTCHEON (POLISH)	
214	3C	*	B07-3287-03	ESCUTCHEON (KNOB)	
216	2D	*	B11-2027-04	REFLECTION SHEET (LCD)	
217	3C	*	B11-2028-04	OPTICAL DIFFUSER (LCD)	
218	3C	*	B19-2532-02	LIGHTING BOARD	
220	2C	*	B19-2535-03	LIGHTING BOARD (LCD)	
222	3C		B43-1518-04	BADGE	
ED1	3C	*	B38-1213-05	LCD (240X64DOTS)	
224	2C		D10-4730-03	LEVER (LOCK)	
225	2C		D10-4731-03	LEVER (PUSH)	
226	1C		D10-7049-04	LEVER (ACCESSORY)	
227	2C		D39-0255-05	DAMPER	
228	2D	*	E29-2136-04	LEAD PLATE	
230	2D	*	E30-6905-05	CORD WITH CONNECTOR (USB)	
△ DC1	1C		E30-6428-05	DC CORD	
FC1	2D		E39-1055-05	FLAT CABLE (MECHA)	
239	2D	*	F11-1870-23	SHIELDING COVER (MECHA)	
245	2D		F29-0637-04	INSULATING COVER (USB CAP)	
△ F1	3D		F52-0023-05	FUSE (MINI BLADE TYPE) (10A)	
247	2C		G01-3171-04	TORSION COIL SPRING (LOCK)	
248	2C		G01-3172-04	TORSION COIL SPRING (PUSH)	
249	2C		G01-3173-04	COMPRESSION SPRING (REAR COVER)	
250	3C		G01-3203-04	COMPRESSION SPRING (REL)	
-		*	H54-4585-03	ITEM CARTON CASE	
258	2C		J19-5203-03	HOLDER (LEFT)	
259	2D		J19-5204-03	HOLDER (RIGHT)	
260	2C		J19-5205-03	HOLDER (REAR COVER)	
261	2C	*	J19-7252-03	HOLDER (LCD)	
262	2D		J21-9977-03	MOUNTING HARDWARE (DUMPER)	
264	1C		J22-0789-03	MOUNTING HARDWARE ASSY	
266	3C	*	K24-4991-03	PUSH KNOB (SEARCH)	
268	2C	*	K24-4995-03	PUSH KNOB (EJECT)	
269	3C	*	K24-4996-03	PUSH KNOB (RELEASE)	
273	3C	*	K28-0381-04	KNOB ASSY (VOL)	
276	3C	*	K28-0383-04	KNOB ASSY (FM/AM)	
280	1C		N99-1730-35	SCREW SET (DISPLAY)	
281	1C		N99-1757-15	SCREW SET	
B	3D		N09-6758-05	TAPTITE SCREW (X34)	
C	3C		N80-2006-48	PAN HEAD TAPTITE SCREW	
D	2C		N80-2008-43	PAN HEAD TAPTITE SCREW	
E	2C		N84-2005-43	PAN HEAD TAPTITE SCREW	
F	2D		N84-2005-48	PAN HEAD TAPTITE SCREW	

Ref. No.	A d d	N e w	Parts No.	Description	Desti- nation
G	2C		N84-2606-43	PAN HEAD TAPTITE SCREW	
H	1D		N86-2604-43	BINDING HEAD TAPTITE SCREW	
J	1D		N86-2606-48	BINDING HEAD TAPTITE SCREW	
283	1C		W01-1710-05	CARRYING CASE	
285	1C		W01-1723-15	COMPACT DISC	
DME1	1D	*	X92-6360-02	MECHANISM ASSY (DXM-9B32W)	
<b>DISPLAY UNIT (X15-1220-10)</b>					
D1			B30-1779-05	LED (1608,SR)	
CN1			E41-2984-05	PIN ASSY	
J1			E58-1008-05	RECTANGULAR RECEPTACLE	
R1			RK73EB2E432J	CHIP R 4.3K J 1/4W	
R2			RK73EB2E000J	CHIP R 0.0 J 1/4W	
R3 ,4			RK73EB2E432J	CHIP R 4.3K J 1/4W	
R5 -8			RK73EB2E102J	CHIP R 1.0K J 1/4W	
R9 ,10			RK73EB2E432J	CHIP R 4.3K J 1/4W	
R11			RK73FB2B331J	CHIP R 330 J 1/8W	
S1			S70-0901-05	TACT SWITCH	
S2			S70-0948-05	TACT SWITCH	
<b>SWITCH UNIT (X16-6520-10)</b>					
D1			B30-1566-05	LED (1608,RED)	
D3 -10			B30-1781-05	LED (1608,BLUE)	
D93 ,94		*	B30-3211-05	LED	
C66			CK73FB1C105K	CHIP C 1.0UF K	
C76 ,77			CK73GB1H103K	CHIP C 0.010UF K	
C85			CK73GB1H104K	CHIP C 0.10UF K	
C86 ,87			CK73GB1H103K	CHIP C 0.010UF K	
C92 -95			CK73GB1C225K	CHIP C 2.2UF K	
C96			CK73GB1A105K	CHIP C 1.0UF K	
C97			CK73GB1H104K	CHIP C 0.10UF K	
C98			CK73GB1A105K	CHIP C 1.0UF K	
CN1		*	E41-3094-05	FLAT CABLE CONNECTOR	
J1			E59-0850-05	RECTANGULAR PLUG	
X1			L78-0872-05	RESONATOR (12MHZ)	
CP1 ,2			RK74HB1J472J	CHIP-COM 4.7K J 1/16W	
CP12			RK74HB1J101J	CHIP-COM 100 J 1/16W	
CP15			RK74HB1J102J	CHIP-COM 1.0K J 1/16W	
CP16			RK74HB1J392J	CHIP-COM 3.9K J 1/16W	
CP17			RK74HB1J331J	CHIP-COM 330 J 1/16W	
CP18			RK74HB1J473J	CHIP-COM 47K J 1/16W	
R1			RK73GB2A331J	CHIP R 330 J 1/10W	
R3 ,4			RK73GB2A471J	CHIP R 470 J 1/10W	
R7 ,8			RK73GB2A471J	CHIP R 470 J 1/10W	
R67			RK73GB2A101J	CHIP R 100 J 1/10W	
R68			RK73GB2A473J	CHIP R 47K J 1/10W	
R69			RK73GB2A101J	CHIP R 100 J 1/10W	
R70			RK73GB2A102J	CHIP R 1.0K J 1/10W	
R71			RK73GB2A473J	CHIP R 47K J 1/10W	
R74			RK73GB2A102J	CHIP R 1.0K J 1/10W	
R76			RK73GB2A103J	CHIP R 10K J 1/10W	

△ Indicates safety critical components.

## PARTS LIST

### SWITCH UNIT (X16-6520-10)

Ref. No.	Add	New	Parts No.	Description	Destination
R79 ,80			RK73GB2A473J	CHIP R 47K J 1/10W	
R83			RK73GB2A106J	CHIP R 10M J 1/10W	
R87			RK73GB2A473J	CHIP R 47K J 1/10W	
R90 -94			RK73GB2A202J	CHIP R 2.0K J 1/10W	
R95 -99			RK73GB2A332J	CHIP R 3.3K J 1/10W	
R117			RK73EB2E181J	CHIP R 180 J 1/4W	
R139			RK73GB2A473J	CHIP R 47K J 1/10W	
R140			RK73GB2A2R2J	CHIP R 2.2 J 1/10W	
S1			T99-0456-15	ROTARY ENCODER	
S2 -4			S70-0901-05	TACT SWITCH	
S6			S70-0901-05	TACT SWITCH	
S8			S70-0951-05	TACT SWITCH	
D40	*		LVS10C270S030	VARISTOR	
D92	*		LVS10C270S030	VARISTOR	
IC1	*		30626MHPB97GP	MICROCONTROLLER IC	
IC3			PIC95603	ANALOGUE IC	
IC7			S-1112B32MCG	ANALOGUE IC	
Q1			KRC406-P	DIGITAL TRANSISTOR	
Q8 ,9			KRC406-P	DIGITAL TRANSISTOR	
Q41			KRC406-P	DIGITAL TRANSISTOR	

### PROCESSOR UNIT (X17-2050-10)

Ref. No.	Add	New	Parts No.	Description	Destination
C101			CK73GB1A105K	CHIP C 1.0UF K	
C102			CC73GCH1H471J	CHIP C 470PF J	
C103-109			CK73GB1H104K	CHIP C 0.10UF K	
C110			CC73GCH1H050C	CHIP C 5.0PF C	
C111			CK73GB1H104K	CHIP C 0.10UF K	
C112			CC73GCH1H050C	CHIP C 5.0PF C	
C113-134			CK73GB1H104K	CHIP C 0.10UF K	
C141-148			CC73GCH1H270J	CHIP C 27PF J	
C151			CK73GB1H104K	CHIP C 0.10UF K	
C191-197			CK73GB1H104K	CHIP C 0.10UF K	
CN101	*		E41-3127-05	PIN ASSY	
CN102	*		E41-3099-05	PIN ASSY	
L101	*		L92-0178-05	CHIP FERRITE	
X101	*		L77-3812-05	CRYSTAL RESONATOR (28.224MHZ)	
CP101-109			RK74GB1J470J	CHIP-COM 47 J 1/16W	
R102			RK73GB2A103J	CHIP R 10K J 1/10W	
R104, 105			RK73GB2A470J	CHIP R 47 J 1/10W	
R106			RK73GB2A101J	CHIP R 100 J 1/10W	
R107			RK73GB2A470J	CHIP R 47 J 1/10W	
R110-116			RK73GB2A470J	CHIP R 47 J 1/10W	
R121-124			RK73GB2A470J	CHIP R 47 J 1/10W	
R150-152			RK73GB2A103J	CHIP R 10K J 1/10W	
R154			RK73GB2A103J	CHIP R 10K J 1/10W	
R160-163			RK73GB2A000J	CHIP R 0.0 J 1/10W	
IC1	*		SAF3560HV	MOS-IC	
IC2	*		V543128164C17	SRAM IC	
IC151	*		EN25F801008B7	ROM IC	
Q101			DTC114EKA	DIGITAL TRANSISTOR	

### CD PLAYER UNIT (X32-6260-00) IN CD MECHA

Ref. No.	Add	New	Parts No.	Description	Destination
C1 ,2			CK73GB1A105K	CHIP C 1.0UF K	
C3			CK73GB1A474K	CHIP C 0.47UF K	
C4 -7			CK73GB1A105K	CHIP C 1.0UF K	

Ref. No.	Add	New	Parts No.	Description	Destination
C9			CK73GB1C104K	CHIP C 0.10UF K	
C11			CK73GB1H153K	CHIP C 0.015UF K	
C12			CK73GB1H103K	CHIP C 0.010UF K	
C21			CK73GB1H103K	CHIP C 0.010UF K	
C22			CC73GCH1H220J	CHIP C 22PF J	
C23			CC73GCH1H180J	CHIP C 18PF J	
C24 ,25			CK73GB1H103K	CHIP C 0.010UF K	
C26			CK73FB0J106K	CHIP C 10UF K	
C27			CK73GB1A105K	CHIP C 1.0UF K	
C28			CK73GB1H103K	CHIP C 0.010UF K	
C29			CK73FB0J106K	CHIP C 10UF K	
C30 -33			CK73GB1H103K	CHIP C 0.010UF K	
C34 ,35			CC73GCH1H150J	CHIP C 15PF J	
C36			CK73GB1H103K	CHIP C 0.010UF K	
C37			CK73GB1A105K	CHIP C 1.0UF K	
C38			CK73GB1H103K	CHIP C 0.010UF K	
C51			CK73GB1C104K	CHIP C 0.10UF K	
C52			CK73GB1H222K	CHIP C 2200PF K	
C53			CK73FB1C105K	CHIP C 1.0UF K	
C54			CK73GB1H103K	CHIP C 0.010UF K	
C55			CK73GB1H332K	CHIP C 3300PF K	
C56			CK73GB1C104K	CHIP C 0.10UF K	
C57			CK73GB1H153K	CHIP C 0.015UF K	
C58			CK73GB1C104K	CHIP C 0.10UF K	
C59			CC73GCH1H680J	CHIP C 68PF J	
C61			CK73GB1C104K	CHIP C 0.10UF K	
C62			CK73FB0J106K	CHIP C 10UF K	
C63			CK73GB1H333K	CHIP C 0.033UF K	
C64			CK73GB1H472K	CHIP C 4700PF K	
C65			CK73GB1C104K	CHIP C 0.10UF K	
C66			CK73GB1H153K	CHIP C 0.015UF K	
C67			CK73GB1H103K	CHIP C 0.010UF K	
C68			CK73GB1C104K	CHIP C 0.10UF K	
C69			CK73FB0J106K	CHIP C 10UF K	
C71			CK73FB0J106K	CHIP C 10UF K	
C73 ,74			CK73GB1H102K	CHIP C 1000PF K	
C75 -77			CK73GB1C104K	CHIP C 0.10UF K	
C78			CK73GB1A105K	CHIP C 1.0UF K	
C79 -81			CK73GB1C104K	CHIP C 0.10UF K	
C83			CC73GCH1H470J	CHIP C 47PF J	
C84			CK73GB1H153K	CHIP C 0.015UF K	
C85			CK73GB1A105K	CHIP C 1.0UF K	
C86			CK73GB1H103K	CHIP C 0.010UF K	
C92			CK73FB1A225K	CHIP C 2.2UF K	
C93			CC73GCH1H101J	CHIP C 100PF J	
C94			CC73GCH1H560J	CHIP C 56PF J	
C101, 102			CK73GB1H103K	CHIP C 0.010UF K	
C113			CK73GB1C104K	CHIP C 0.10UF K	
C114			CK73GB1H103K	CHIP C 0.010UF K	
CN1			E41-2954-05	FLAT CABLE CONNECTOR	
CN2			E41-2083-15	FLAT CABLE CONNECTOR	
X1			L77-2964-05	CRYSTAL RESONATOR (9.00MHZ)	
X2			L77-2921-15	CRYSTAL RESONATOR (32.768KHZ)	
X3			L78-1221-05	RESONATOR (16.93MHZ)	

△ Indicates safety critical components.

## PARTS LIST

### CD PLAYER UNIT (X32-6260-00) IN CD MECHA

Ref. No.	Add	New	Parts No.	Description	Destination	Ref. No.	Add	New	Parts No.	Description	Destination
CP10			RK74GA1J101J	CHIP-COM 100 J 1/16W		R110			RK73GB2A913J	CHIP R 91K J 1/10W	
CP11,12			RK74GB1J101J	CHIP-COM 100 J 1/16W		R112,113			RK73GB2A4R7J	CHIP R 4.7 J 1/10W	
CP15			RK74GB1J103J	CHIP-COM 10K J 1/16W		R115			RK73GB2A105J	CHIP R 1.0M J 1/10W	
CP22			RK74GB1J103J	CHIP-COM 10K J 1/16W		R116			RK73GB2A681J	CHIP R 680 J 1/10W	
CP32			RK74GA1J101J	CHIP-COM 100 J 1/16W		R117-121			RK73GB2A103J	CHIP R 10K J 1/10W	
R1 ,2			RK73EB2E4R7J	CHIP R 4.7 J 1/4W		R123			RK73GB2A104J	CHIP R 100K J 1/10W	
R3			RK73GB2A202J	CHIP R 2.0K J 1/10W		R127			RK73GB2A153J	CHIP R 15K J 1/10W	
R4			RK73GB2A103J	CHIP R 10K J 1/10W		R128			RK73GB2A334J	CHIP R 330K J 1/10W	
R10			RK73GB2A000J	CHIP R 0.0 J 1/10W		R131			RK73GB2A204J	CHIP R 200K J 1/10W	
R19			RK73GB2A223J	CHIP R 22K J 1/10W		R132			RK73GB2A101J	CHIP R 100 J 1/10W	
R21			RK73GB2A102J	CHIP R 1.0K J 1/10W		R136			RK73GB2A363J	CHIP R 36K J 1/10W	
R23			RK73GB2A223J	CHIP R 22K J 1/10W		R137			RK73GB2A223J	CHIP R 22K J 1/10W	
R24			RK73GB2A101J	CHIP R 100 J 1/10W		R139			RK73GB2A393J	CHIP R 39K J 1/10W	
R25			RK73GB2A104J	CHIP R 100K J 1/10W		R151			RK73GB2A333J	CHIP R 33K J 1/10W	
R26			RK73GB2A2R2J	CHIP R 2.2 J 1/10W		R152			RK73GB2A223J	CHIP R 22K J 1/10W	
R27			RK73GB2A101J	CHIP R 100 J 1/10W		R173-178			RK73GB2A2R2J	CHIP R 2.2 J 1/10W	
R28 ,29			RK73GB2A102J	CHIP R 1.0K J 1/10W		R180			RK73GB2A102J	CHIP R 1.0K J 1/10W	
R30			RK73GB2A223J	CHIP R 22K J 1/10W		S1 ,2			S68-0924-05	PUSH SWITCH	
R31			RK73GB2A000J	CHIP R 0.0 J 1/10W		D1			DAP202U	DIODE	
R33			RK73GB2A223J	CHIP R 22K J 1/10W		D2 ,3			DA204U	DIODE	
R36			RK73GB2A102J	CHIP R 1.0K J 1/10W		IC1			92CD28AFG7C32	MICROCONTROLLER IC	
R38			RK73GB2A102J	CHIP R 1.0K J 1/10W		IC2			TC94A92FG-301	MOS-IC	
R41			RK73GB2A223J	CHIP R 22K J 1/10W		IC3			BD8222EFV	ANALOGUE IC	
R44			RK73GB2A223J	CHIP R 22K J 1/10W		IC4			MFI341S2162	MICROPROCESSOR IC	
R45			RK73GB2A101J	CHIP R 100 J 1/10W		IC5			74AHCT08PW	MOS-IC	
R47			RK73GB2A000J	CHIP R 0.0 J 1/10W		IC6			74LVCO8APW	MOS-IC	
R48			RK73GB2A105J	CHIP R 1.0M J 1/10W		IC7			XC6415S001P1	MOS-IC	
R49			RK73GB2A102J	CHIP R 1.0K J 1/10W		IC8			BR24L04FV-W	ROM IC	
R50			RK73GB2A223J	CHIP R 22K J 1/10W		IC9			XC6219B332MR	ANALOGUE IC	
R51			RK73GB2A102J	CHIP R 1.0K J 1/10W		Q3			RUE003N02	FET	
R52			RK73GB2A100J	CHIP R 10 J 1/10W		Q5			2SA1577	TRANSISTOR	
R53			RK73GB2A153J	CHIP R 15K J 1/10W		Q6			DTC114YUA	DIGITAL TRANSISTOR	
R54			RK73GB2A100J	CHIP R 10 J 1/10W		Q7			2SB0970	TRANSISTOR	
R55			RK73GB2A153J	CHIP R 15K J 1/10W		Q9			DTC114YUA	DIGITAL TRANSISTOR	
R57			RK73GB2A223J	CHIP R 22K J 1/10W		<b>ELECTRIC UNIT (X34-6320-10)</b>					
R58 ,59			RK73GB2A101J	CHIP R 100 J 1/10W		C1			CD04AZ1C332M2	ELECTRO 3300UF 16WV	
R63			RK73GB2A223J	CHIP R 22K J 1/10W		C10 ,11			CK73GB1A105K	CHIP C 1.0UF K	
R65 ,66			RK73GB2A332J	CHIP R 3.3K J 1/10W		C13			CD04AY1A221M	ELECTRO 220UF 10WV	
R67 -69			RK73GB2A101J	CHIP R 100 J 1/10W		C14			CK73GB1A105K	CHIP C 1.0UF K	
R70			RK73GB2A223J	CHIP R 22K J 1/10W		C21			C90-6851-05	ELECTRO 220UF 25WV	
R81 ,82			RK73GB2A101J	CHIP R 100 J 1/10W		C23			CD04BA1C100M	ELECTRO 10UF 16WV	
R84			RK73GB2A101J	CHIP R 100 J 1/10W		C24			CD04BA0J101M	ELECTRO 100UF 6.3WV	
R86			RK73GB2A101J	CHIP R 100 J 1/10W		C31			CK73GB1H104K	CHIP C 0.10UF K	
R88			RK73GB2A101J	CHIP R 100 J 1/10W		C43			CD04AT1C100M	ELECTRO 10UF 16WV	
R90 -94			RK73GB2A101J	CHIP R 100 J 1/10W		C54 ,55			CK73EB1H475K	CHIP C 4.7UF K	
R95 -98			RK73GB2A223J	CHIP R 22K J 1/10W		C61			CK73GB1H104K	CHIP C 0.10UF K	
R101			RK73GB2A221J	CHIP R 220 J 1/10W		C62			CC73GCH1H471J	CHIP C 470PF J	
R102			RK73GB2A4R7J	CHIP R 4.7 J 1/10W		C63			CK73GB1A474K	CHIP C 0.47UF K	
R103			RK73GB2A102J	CHIP R 1.0K J 1/10W		C64			CK73FB0J106K	CHIP C 10UF K	
R104			RK73GB2A225J	CHIP R 2.2M J 1/10W		C65			CK73GB1H102K	CHIP C 1000PF K	
R105			RK73GB2A104J	CHIP R 100K J 1/10W		C68			CK73GB1H104K	CHIP C 0.10UF K	
R106			RK73GB2A472J	CHIP R 4.7K J 1/10W		C71			CK73GB1H473K	CHIP C 0.047UF K	
R107			RK73GB2A560J	CHIP R 56 J 1/10W		C72			CC73GCH1H471J	CHIP C 470PF J	
R108			RK73GB2A333J	CHIP R 33K J 1/10W							
R109			RK73GB2A622J	CHIP R 6.2K J 1/10W							

△ Indicates safety critical components.

## PARTS LIST

### ELECTRIC UNIT (X34-6320-10)

Ref. No.	A	N	Parts No.	Description	Desti-	Ref. No.	A	N	Parts No.	Description	Desti-
	d	e			nation		d	e			nation
C73			CK73GB1A474K	CHIP C 0.47UF K		C516			CK73GB1A105K	CHIP C 1.0UF K	
C74			CK73FB0J106K	CHIP C 10UF K		C517-520			CK73GB1C224K	CHIP C 0.22UF K	
C75			CK73GB1H102K	CHIP C 1000PF K		C521			CK73FB1C105K	CHIP C 1.0UF K	
C76			CK73EB1E105K	CHIP C 1.0UF K		C601			CK73GB1H104K	CHIP C 0.10UF K	
C77			CK73FB0J106K	CHIP C 10UF K		C602			CK73GB1H103K	CHIP C 0.010UF K	
C78			CK73GB1H104K	CHIP C 0.10UF K		C603,604			CC73GCH1H180J	CHIP C 18PF J	
C83			CK73GB1H104K	CHIP C 0.10UF K		C605,606			CK73GB1H103K	CHIP C 0.010UF K	
C84			CK73FB0J106K	CHIP C 10UF K		C608-610			CK73GB1H103K	CHIP C 0.010UF K	
C101			CK73GB1H104K	CHIP C 0.10UF K		C612			CK73GB1H103K	CHIP C 0.010UF K	
C102			CK73FB0J106K	CHIP C 10UF K		C614			CK73GB1H103K	CHIP C 0.010UF K	
C103			CK73EB1E105K	CHIP C 1.0UF K		C615			CK73GB1H104K	CHIP C 0.10UF K	
C104			CK73FB0J106K	CHIP C 10UF K		C682			CK73GB1H103K	CHIP C 0.010UF K	
C121			CK73GB1H103K	CHIP C 0.010UF K		C751			CK73GB1H103K	CHIP C 0.010UF K	
C141			CD04AS1H3R3M	ELECTRO 3.3UF 50WV		C752			CD04AS0J470M	ELECTRO 47UF 6.3WV	
C142			CK73GB1A105K	CHIP C 1.0UF K		C753			CK73GB1H103K	CHIP C 0.010UF K	
C143			CK73GB1H104K	CHIP C 0.10UF K		C754			CD04AS0J470M	ELECTRO 47UF 6.3WV	
C151			CK73GB1H103K	CHIP C 0.010UF K		C755			CK73GB1H103K	CHIP C 0.010UF K	
C152			CK73GB1H223K	CHIP C 0.022UF K		C801			CK73GB1H103K	CHIP C 0.010UF K	
C153			CK73GB1A105K	CHIP C 1.0UF K		C802			CD04AS1V100M	ELECTRO 10UF 35WV	
C201			CK73GB1A105K	CHIP C 1.0UF K		C803			CK73GB1H103K	CHIP C 0.010UF K	
C211,212			CK73GB1H104K	CHIP C 0.10UF K		C804			CD04AS1V100M	ELECTRO 10UF 35WV	
C213			CD04BF1C221M	ELECTRO 220UF 16WV		C805			CK73GB1H103K	CHIP C 0.010UF K	
C351			CD04AS1C220M	ELECTRO 22UF 16WV		C806			CD04AS1V100M	ELECTRO 10UF 35WV	
C352,353			CK73GB1H102K	CHIP C 1000PF K		C851			CK73GB1H103K	CHIP C 0.010UF K	
C354			CD04AS1V100M	ELECTRO 10UF 35WV		C852			CK73GB1A105K	CHIP C 1.0UF K	
C370			CC73GCH1H120J	CHIP C 12PF J		C853-856			CK73GB1H103K	CHIP C 0.010UF K	
C372			CC73GCH1H120J	CHIP C 12PF J		C858			CK73GB1H103K	CHIP C 0.010UF K	
C373			CK73GB1H103K	CHIP C 0.010UF K		CN201			E41-1701-05	PIN ASSY	
C375-377			CK73GB1H103K	CHIP C 0.010UF K		CN680			E40-9747-05	PIN ASSY	
C378			CD04AS1V100M	ELECTRO 10UF 35WV		CN701			E41-2352-05	FLAT CABLE CONNECTOR	
C379			CK73GB0J225K	CHIP C 2.2UF K		J1			E58-0991-05	RECTANGULAR RECEPTACLE	
C381			CD04AS1C470M	ELECTRO 47UF 16WV		J401			E63-0960-05	PIN JACK (3-PRE)	
C383-388			CK73GB1H222K	CHIP C 2200PF K		J421			E11-0625-05	PHONE JACK (LGY6502-0900)	
C401,402			CK73EB1A106K	CHIP C 10UF K		J431			E56-0855-05	CYLINDRICAL RECEPTACLE	
C405,406			CK73EB1A106K	CHIP C 10UF K		W321	2D		E30-6438-05	CORD WITH PLUG (ANT)	
C409,410			CK73EB1A106K	CHIP C 10UF K		WH151	2D		E30-6822-15	WIRING HARNESS (REMOTE)	
C421,422			CK73GB1A105K	CHIP C 1.0UF K		L1			L33-2365-05	CHOKE COIL ASSY	
C423			CD04AS0J470M	ELECTRO 47UF 6.3WV		L60			L92-0639-05	CHIP FERRITE (100MHZ)	
C431			CK73GB1A105K	CHIP C 1.0UF K		L61			L33-2453-05	SMALL FIXED INDUCTOR	
C432			CD04AS0J470M	ELECTRO 47UF 6.3WV		L70			L92-0639-05	CHIP FERRITE (100MHZ)	
C433			CK73GB1A105K	CHIP C 1.0UF K		L71			L33-2453-05	SMALL FIXED INDUCTOR	
C451-458			CK73GB1A105K	CHIP C 1.0UF K		L600			L92-0378-05	CHIP FERRITE	
C461			CK73GB1H103K	CHIP C 0.010UF K		L752			L41-4795-33	SMALL FIXED INDUCTOR (4.7UH)	
C462			CD04AS1H2R2M	ELECTRO 2.2UF 50WV		L753			L41-1095-33	SMALL FIXED INDUCTOR (1UH)	
C463			CK73GB1A474K	CHIP C 0.47UF K		L801-803			L92-0642-05	CHIP FERRITE	
C464			CK73GB1A105K	CHIP C 1.0UF K		X370			L77-3810-05	CRYSTAL RESONATOR (11.2896MHZ)	
C465			CK73GB1A474K	CHIP C 0.47UF K		X600		*	L78-1231-05	RESONATOR (12MHZ)	
C466			CK73GB1A105K	CHIP C 1.0UF K		X601			L77-2921-15	CRYSTAL RESONATOR (32.768KHZ)	
C469-472			CK73GB1A105K	CHIP C 1.0UF K		X851			L78-0889-05	RESONATOR	
C474			CK73GB1A105K	CHIP C 1.0UF K		K	2D		N80-3008-48	PAN HEAD TAPTITE SCREW	
C476			CD04AS1C470M	ELECTRO 47UF 16WV		L	2D		N83-3005-48	PAN HEAD TAPTITE SCREW	
C479-482			CC73GCH1H330J	CHIP C 33PF J		M	2D		N83-3008-48	PAN HEAD TAPTITE SCREW	
C500-503			CC73GCH1H330J	CHIP C 33PF J		N	2D		N83-3016-48	PAN HEAD TAPTITE SCREW	
C505			CK73GB1A105K	CHIP C 1.0UF K		P	3D		N86-2604-43	BINDING HEAD TAPTITE SCREW	
C508			CD04BA1C100M	ELECTRO 10UF 16WV							

△ Indicates safety critical components.

## PARTS LIST

### ELECTRIC UNIT (X34-6320-10)

Ref. No.	Add	New	Parts No.	Description	Destination	Ref. No.	Add	New	Parts No.	Description	Destination
CP603			RK74GA1J101J	CHIP-COM 100 J 1/16W		R356			RK73GB2A2R2J	CHIP R 2.2 J 1/10W	
CP604			RK74HB1J101J	CHIP-COM 100 J 1/16W		R357			RK73FB2B102J	CHIP R 1.0K J 1/8W	
CP607			RK74GA1J101J	CHIP-COM 100 J 1/16W		R370			RK73EB2E2R2J	CHIP R 2.2 J 1/4W	
CP609			RK74HB1J101J	CHIP-COM 100 J 1/16W		R371			RK73GB2A152J	CHIP R 1.5K J 1/10W	
CP613			RK74GA1J472J	CHIP-COM 4.7K J 1/16W		R373-378			RK73GB2A471J	CHIP R 470 J 1/10W	
CP852			RK74GA1J472J	CHIP-COM 4.7K J 1/16W		R401,402			RK73GB2A331J	CHIP R 330 J 1/10W	
R1 ,2			RK73EB2E103J	CHIP R 10K J 1/4W		R403,404			RK73GB2A223J	CHIP R 22K J 1/10W	
R11			RK73FB2B221J	CHIP R 220 J 1/8W		R405,406			RK73FB2B181J	CHIP R 180 J 1/8W	
R12			RK73GH2A243D	CHIP R 24K D 1/10W		R407,408			RK73GB2A331J	CHIP R 330 J 1/10W	
R13			RK73GH2A432D	CHIP R 4.3K D 1/10W		R409,410			RK73GB2A223J	CHIP R 22K J 1/10W	
R21			RK73FB2B123J	CHIP R 12K J 1/8W		R411,412			RK73FB2B181J	CHIP R 180 J 1/8W	
R31			RK73FB2B152J	CHIP R 1.5K J 1/8W		R413,414			RK73GB2A331J	CHIP R 330 J 1/10W	
R41			RK73FB2B102J	CHIP R 1.0K J 1/8W		R415,416			RK73GB2A223J	CHIP R 22K J 1/10W	
R61			RK73GH2A203D	CHIP R 20K D 1/10W		R417,418			RK73FB2B181J	CHIP R 180 J 1/8W	
R62			RK73GB2A153J	CHIP R 15K J 1/10W		R421,422			RK73EB2E101J	CHIP R 100 J 1/4W	
R63			RK73GH2A153D	CHIP R 15K D 1/10W		R423,424			RK73GB2A123J	CHIP R 12K J 1/10W	
R64			RK73GH2A823D	CHIP R 82K D 1/10W		R425			RK73EB2E470J	CHIP R 47 J 1/4W	
R65			RK73GH2A303D	CHIP R 30K D 1/10W		R426			RK73GB2A102J	CHIP R 1.0K J 1/10W	
R67			RK73GB2A333J	CHIP R 33K J 1/10W		R431-435			RK73EB2E432J	CHIP R 4.3K J 1/4W	
R68			RK73GB2A473J	CHIP R 47K J 1/10W		R436			RK73EB2E101J	CHIP R 100 J 1/4W	
R71			RK73GH2A333D	CHIP R 33K D 1/10W		R437			RK73EB2E100J	CHIP R 10 J 1/4W	
R72			RK73GB2A153J	CHIP R 15K J 1/10W		R438			RK73EB2E4R7J	CHIP R 4.7 J 1/4W	
R73			RK73GH2A103D	CHIP R 10K D 1/10W		R439			RK73EB2E100J	CHIP R 10 J 1/4W	
R74			RK73GH2A333D	CHIP R 33K D 1/10W		R440			RK73EB2E432J	CHIP R 4.3K J 1/4W	
R76			RK73GB2A102J	CHIP R 1.0K J 1/10W		R441			RK73EB2E101J	CHIP R 100 J 1/4W	
R80			RK73GH2A473D	CHIP R 47K D 1/10W		R442			RK73GB2A102J	CHIP R 1.0K J 1/10W	
R81			RK73GB2A752J	CHIP R 7.5K J 1/10W		R454			RK73GB2A103J	CHIP R 10K J 1/10W	
R82			RK73GB2A473J	CHIP R 47K J 1/10W		R455			RK73EB2E2R2J	CHIP R 2.2 J 1/4W	
R83			RK73PB2H100J	CHIP R 10 J 1/2W		R462,463			RK73GB2A332J	CHIP R 3.3K J 1/10W	
R121			RK73FB2B203J	CHIP R 20K J 1/8W		R464,465			RK73GB2A182J	CHIP R 1.8K J 1/10W	
R122,123			RK73GB2A103J	CHIP R 10K J 1/10W		R466			RK73GB2A683J	CHIP R 68K J 1/10W	
R124			RK73FB2B683J	CHIP R 68K J 1/8W		R467			RK73GB2A223J	CHIP R 22K J 1/10W	
R125			RK73GB2A473J	CHIP R 47K J 1/10W		R468			RK73GB2A103J	CHIP R 10K J 1/10W	
R126			RK73GB2A104J	CHIP R 100K J 1/10W		R469			RK73GB2A682J	CHIP R 6.8K J 1/10W	
R127			RK73EB2E102J	CHIP R 1.0K J 1/4W		R500			RK73GB2A470J	CHIP R 47 J 1/10W	
R128			RK73EB2E473J	CHIP R 47K J 1/4W		R501,502			RK73GB2A000J	CHIP R 0.0 J 1/10W	
R129			RK73GB2A183J	CHIP R 18K J 1/10W		R504			RK73GB2A470J	CHIP R 47 J 1/10W	
R134,135			RK73EB2E102J	CHIP R 1.0K J 1/4W		R505			RK73GB2A153J	CHIP R 15K J 1/10W	
R141			RK73FB2B472J	CHIP R 4.7K J 1/8W		R506			RK73GB2A473J	CHIP R 47K J 1/10W	
R142			RK73PB2H561J	CHIP R 560 J 1/2W		R507			RK73GB2A432J	CHIP R 4.3K J 1/10W	
R143			RK73GB2A223J	CHIP R 22K J 1/10W		R508			RK73GB2A100J	CHIP R 10 J 1/10W	
R144			RK73PB2H561J	CHIP R 560 J 1/2W		R509			RK73GB2A470J	CHIP R 47 J 1/10W	
R145			RK73FB2B472J	CHIP R 4.7K J 1/8W		R512			RK73GB2A473J	CHIP R 47K J 1/10W	
R146,147			RK73PB2H221J	CHIP R 220 J 1/2W		R514			RK73GB2A331J	CHIP R 330 J 1/10W	
R148			RK73GB2A223J	CHIP R 22K J 1/10W		R515			RK73GB2A470J	CHIP R 47 J 1/10W	
R149,150			RK73PB2H561J	CHIP R 560 J 1/2W		R603,604			RK73GB2A473J	CHIP R 47K J 1/10W	
R151			RK73GB2A104J	CHIP R 100K J 1/10W		R606			RK73GB2A473J	CHIP R 47K J 1/10W	
R152			RK73GB2A473J	CHIP R 47K J 1/10W		R607			RK73GB2A103J	CHIP R 10K J 1/10W	
R153			RK73GB2A104J	CHIP R 100K J 1/10W		R608,609			RK73GB2A104J	CHIP R 100K J 1/10W	
R161			RK73EB2E102J	CHIP R 1.0K J 1/4W		R610,611			RK73GB2A473J	CHIP R 47K J 1/10W	
R211			RK73GB2A101J	CHIP R 100 J 1/10W		R613			RK73GB2A473J	CHIP R 47K J 1/10W	
R213			RK73GB2A223J	CHIP R 22K J 1/10W		R614			RK73GB2A101J	CHIP R 100 J 1/10W	
R353			RK73GB2A362J	CHIP R 3.6K J 1/10W		R615			RK73GB2A102J	CHIP R 1.0K J 1/10W	
R354			RK73GB2A432J	CHIP R 4.3K J 1/10W		R616			RK73GB2A222J	CHIP R 2.2K J 1/10W	
R355			RK73GB2A562J	CHIP R 5.6K J 1/10W		R617			RK73GB2A102J	CHIP R 1.0K J 1/10W	

△ Indicates safety critical components.

## PARTS LIST

### ELECTRIC UNIT (X34-6320-10)

Ref. No.	A d d	N e w	Parts No.	Description	Desti- nation
R618			RK73GB2A223J	CHIP R 22K J 1/10W	
R619			RK73GB2A103J	CHIP R 10K J 1/10W	
R620			RK73GB2A473J	CHIP R 47K J 1/10W	
R621			RK73GB2A101J	CHIP R 100 J 1/10W	
R622			RK73GB2A473J	CHIP R 47K J 1/10W	
R624			RK73GB2A104J	CHIP R 100K J 1/10W	
R626,627			RK73GB2A104J	CHIP R 100K J 1/10W	
R632			RK73GB2A104J	CHIP R 100K J 1/10W	
R633,634			RK73GB2A471J	CHIP R 470 J 1/10W	
R635,636			RK73GB2A104J	CHIP R 100K J 1/10W	
R638			RK73GB2A471J	CHIP R 470 J 1/10W	
R641			RK73GB2A473J	CHIP R 47K J 1/10W	
R643			RK73GB2A102J	CHIP R 1.0K J 1/10W	
R646			RK73GB2A101J	CHIP R 100 J 1/10W	
R647			RK73GB2A222J	CHIP R 2.2K J 1/10W	
R649			RK73GB2A104J	CHIP R 100K J 1/10W	
R650			RK73GB2A473J	CHIP R 47K J 1/10W	
R653			RK73GB2A101J	CHIP R 100 J 1/10W	
R654			RK73GB2A102J	CHIP R 1.0K J 1/10W	
R655			RK73GB2A101J	CHIP R 100 J 1/10W	
R657,658			RK73GB2A104J	CHIP R 100K J 1/10W	
R680			RK73GB2A471J	CHIP R 470 J 1/10W	
R681			RK73GB2A104J	CHIP R 100K J 1/10W	
R682			RK73GB2A102J	CHIP R 1.0K J 1/10W	
R683			RK73GB2A472J	CHIP R 4.7K J 1/10W	
R684			RK73GB2A223J	CHIP R 22K J 1/10W	
R686			RK73EB2E432J	CHIP R 4.3K J 1/4W	
R757-760			RK73GB2A101J	CHIP R 100 J 1/10W	
R801-803			RK73GB2A101J	CHIP R 100 J 1/10W	
R807			RK73GB2A101J	CHIP R 100 J 1/10W	
R851			RK73GB2A223J	CHIP R 22K J 1/10W	
R855,856			RK73GB2A472J	CHIP R 4.7K J 1/10W	
R857			RK73GB2A102J	CHIP R 1.0K J 1/10W	
R858			RK73GB2A223J	CHIP R 22K J 1/10W	
R862,863			RK73GB2A101J	CHIP R 100 J 1/10W	
R864			RK73GB2A223J	CHIP R 22K J 1/10W	
R870			RK73GB2A183J	CHIP R 18K J 1/10W	
R871			RK73GB2A333J	CHIP R 33K J 1/10W	
R872-875			RK73GB2A223J	CHIP R 22K J 1/10W	
R880			RK73GB2A223J	CHIP R 22K J 1/10W	
R901			RK73EB2E000J	CHIP R 0.0 J 1/4W	
R905,906			RK73GB2A000J	CHIP R 0.0 J 1/10W	
W756			R92-2053-05	CHIP R 0 OHM J 1/8W	
S680			S74-0809-05	MICRO SWITCH	
D1			S2V60-5009F46	DIODE	
D21			D1FJ4	DIODE	
D22			UDZW5.6(B)	ZENER DIODE	
D31			UDZW8.2(B)	ZENER DIODE	
D41			UDZW11(B)	ZENER DIODE	
D61			CMS14	DIODE	
D71			CMS14	DIODE	
D121			UDZW6.8(B)	ZENER DIODE	
D123			UDZW6.8(B)	ZENER DIODE	
D124			UDZW6.2(B)	ZENER DIODE	

Ref. No.	A d d	N e w	Parts No.	Description	Desti- nation
D141,142			1SR154-400	DIODE	
D143			1SS355	DIODE	
D144,145			1SR154-400	DIODE	
D151			UDZW4.7(B)	ZENER DIODE	
D161			UDZW6.2(B)	ZENER DIODE	
D201,202		*	LVS10C270S030	VARISTOR	
D350			1SR154-400	DIODE	
D352			UDZW5.6(B)	ZENER DIODE	
D370			DA204U	DIODE	
D401,402			DAP202U	DIODE	
D421-423			UDZW6.8(B)	ZENER DIODE	
D431-433			UDZW6.8(B)	ZENER DIODE	
D434			UDZW6.2(B)	ZENER DIODE	
D439			UDZW6.2(B)	ZENER DIODE	
D451-453			DAP202U	DIODE	
D456,457			DAP202U	DIODE	
D458			DA204U	DIODE	
D459			1SS355	DIODE	
D460-465			UDZW6.8(B)	ZENER DIODE	
D501			DAP202U	DIODE	
D504			1SR154-400	DIODE	
D508			1SR154-400	DIODE	
D682			UDZW6.2(B)	ZENER DIODE	
D684			UDZW6.2(B)	ZENER DIODE	
D691			DA204U	DIODE	
IC10			XC6201P502PR	ANALOGUE IC	
IC11			M5237ML-CF0J	ANALOGUE IC	
IC61			LT3685EMSE	ANALOGUE IC	
IC71			LT3685EMSE	ANALOGUE IC	
IC74			S-1132B33U5T1G	ANALOGUE IC	
IC75		*	XC6209B502P1	ANALOGUE IC	
IC101			S-1132B18U5T1G	ANALOGUE IC	
IC102			XC6219B122PR	ANALOGUE IC	
IC211			BD6538G	MOS-IC	
IC371			AK7600VF	MOS-IC	
IC451		*	E-TDA7716	ANALOGUE IC	
IC500			TB2923HQ	ANALOGUE IC	
IC600			XC6120N362N1	MOS-IC	
IC601			M24C16-RDW6P	ROM IC	
IC602		*	30624MGPB98GP	MICROCONTROLLER IC	
IC604			74HC2G02DP	MOS-IC	
IC851		*	W05-1504-00	MICROCONTROLLER IC	
IC852		*	M24256BRDW6TP	ROM IC	
Q11			2SB1565	TRANSISTOR	
Q12			DTA124EUA	DIGITAL TRANSISTOR	
Q13			DTC124EUA	DIGITAL TRANSISTOR	
Q21			2SB1565	TRANSISTOR	
Q22			2SC4081	TRANSISTOR	
Q31			2SB1565	TRANSISTOR	
Q32			2SC4081	TRANSISTOR	
Q33			DTA124EUA	DIGITAL TRANSISTOR	
Q34			DTC124EUA	DIGITAL TRANSISTOR	
Q41			2SB1565	TRANSISTOR	
Q42			2SC4081	TRANSISTOR	
Q43			DTA124EUA	DIGITAL TRANSISTOR	

△ Indicates safety critical components.

## PARTS LIST

### ELECTRIC UNIT (X34-6320-10)

Ref. No.	Add	New	Parts No.	Description	Destination
Q44			DTC124EUA	DIGITAL TRANSISTOR	
Q61			DTC144EUA	DIGITAL TRANSISTOR	
Q72			DTC144EUA	DIGITAL TRANSISTOR	
Q121-123			2SC4081	TRANSISTOR	
Q141			2SB1188(Q,R)	TRANSISTOR	
Q142			2SA1576A	TRANSISTOR	
Q143			DTA114EUA	DIGITAL TRANSISTOR	
Q144			DTC114YUA	DIGITAL TRANSISTOR	
Q145			2SB1188(Q,R)	TRANSISTOR	
Q146			DTC114YUA	DIGITAL TRANSISTOR	
Q151			DTC144EUA	DIGITAL TRANSISTOR	
Q350			2SC4081	TRANSISTOR	
Q351			2SC5053	TRANSISTOR	
Q352			DTA124EUA	DIGITAL TRANSISTOR	
Q353			DTC124EUA	DIGITAL TRANSISTOR	
Q401-406			DTC143TUA	DIGITAL TRANSISTOR	
Q407,408			KRA303-P	DIGITAL TRANSISTOR	
Q451			2SC4081	TRANSISTOR	
Q681			KRA307-P	DIGITAL TRANSISTOR	
Q682			DTC124EUA	DIGITAL TRANSISTOR	
Q683			2SA1576A	TRANSISTOR	
Q766			KRC406-P	DIGITAL TRANSISTOR	
Q768			KRC406-P	DIGITAL TRANSISTOR	
TH500			PRF18BE471QS2	POSITIVE RESISTOR	
A1	2D	*	X86-4220-10	TUNER UNIT	
A2	2D	*	X17-2050-10	PROCESSOR UNIT	
<b>MECHANISM ASSY (X92-6360-02) DXM-9B32W</b>					
1	2B		A10-5450-53	CHASSIS ASSY	
3	3B		A10-5452-41	CHASSIS	
4	1B		A10-5453-32	CHASSIS	
12	3A		D10-4993-52	LEVER	
13	1B		D10-4991-22	ARM	
14	1B		D10-4992-13	ARM	
15	2A		D10-4994-02	SLIDER	
16	2A		D10-4995-03	SLIDER	
17	2B		D10-4996-02	SLIDER	
18	2A		D10-4997-03	LEVER	
19	1A		D10-4998-03	ARM	
20	2A		D10-4999-03	ARM	
21	2A		D10-7001-03	ARM	
22	2A		D10-7002-03	ARM	
23	2A		D10-7003-03	ARM	
24	2A		D13-2445-04	GEAR	
25	2A		D13-2446-04	GEAR	
27	2A		D13-2448-04	GEAR	
28	2A		D13-2449-04	GEAR	
29	2A		D13-2450-04	GEAR	
30	2A		D13-2451-04	GEAR	
31	2A		D13-2452-04	GEAR	
32	2A		D13-2453-04	GEAR	
33	2A		D13-2454-04	GEAR	
34	2A		D13-2455-04	GEAR	
35	2B		D13-2456-03	RACK (GEAR)	
36	2A		D14-1028-04	ROLLER	

Ref. No.	Add	New	Parts No.	Description	Destination
37	3A		D21-2507-04	SHAFT	
38	2B		D21-2508-04	SHAFT	
39	3A		D23-0963-04	RETAINER	
40	3B		D39-0277-15	DAMPER	
41	3B		D39-0278-15	DAMPER	
46	1B		G01-4682-34	TORSION COIL SPRING	
47	3A		G01-4683-24	EXTENSION SPRING	
48	2A		G01-4684-04	EXTENSION SPRING	
49	2B		G01-4685-04	EXTENSION SPRING	
50	1B		G01-4686-14	EXTENSION SPRING	
51	3A		G01-4688-14	EXTENSION SPRING	
52	3A		G01-4692-24	TORSION COIL SPRING	
53	2B		G02-1587-04	FLAT SPRING	
54	3A		G02-1588-04	FLAT SPRING	
55	1B		G13-1297-04	CUSHION	
56	1B		G13-1299-14	CUSHION	
57	1A		G16-1715-04	SHEET	
61	1B		J11-0675-03	CLAMPER	
64	2A		J19-7210-21	HOLDER	
65	2B		J19-7225-04	HOLDER	
66	1B		J22-0706-03	MOUNTING HARDWARE	
67	1A		J22-0707-12	MOUNTING HARDWARE	
68	1B		J90-1166-11	GUIDE	
69	2B		J90-1168-03	RAIL	
A	1A		N09-6108-15	TAPTITE SCREW (M2X3.5)	
B	2B		N09-6426-15+	MACHINE SCREW	
C	2B		N09-6735-05	TAPTITE SCREW	
D	2B		N09-6737-15	MACHINE SCREW	
E	2B		N09-6738-15	TAPTITE SCREW	
F	2A		N19-2335-14	FLAT WASHER	
G	2B		N35-2003-48	BINDING HEAD MACHINE SCREW	
H	2B		N39-1720-48	PAN HEAD MACHINE SCREW	
76	2A		S68-0921-05	PUSH SWITCH	
DM1	2B		X94-2090-00	SPINDLE MOTOR ASSY	
DM2	2B		X94-2100-00	FEED MOTOR ASSY (LOAD/SLED)	
DPU1	2B		X93-2260-01	OPTICAL PICKUP ASSY	

△ Indicates safety critical components.